

TILMOR

PRODUCT INFORMER

ISSUE 2 | 2021

This issue's featured farmer

**KRISTEN
BAUGHMAN**
OF CURLY GIRL FARM





THE TILMOR STORY

The Tilmor story has deep roots in agriculture and manufacturing. Over four generations of the Marvin and Mary Steiner family have farmed in the rolling hills of Northeast Ohio and have extensive experience with international agriculture. This history enabled the family to better understand the unique needs of farmers around the corner and across the globe. A strong mechanical aptitude helped them to solve problems on the farm and led to the eventual creation of several modern manufacturing businesses.

Today the Tilmor team is committed to support growers with tools and equipment they need to grow healthy and wholesome food for their families and communities.



CURLY GIRL FARM pg. 17



THE TILMOR TRACTOR pg. 5

03 | TILMOR POWER OX

05 | TILMOR 520 TRACTOR

09 | BASKET WEEDING & TINE WEEDING

11 | FINGER WEEDING, SPYDERS & DISCS

13 | S-TINES, SWEEPS & VEGETABLE KNIVES

15 | TWO-WHEEL PACKAGES

17 | FARMER'S SPOTLIGHT

19 | VINYARD WEEDING

20 | MOUNTING & UNDERCUTTERS

21 | PLASTIC MULCH LAYING AND REMOVAL

23 | TOOLBARS, MODBARS, MORE

25 | SHANKS & CLAMPS

27 | JANG & CLEAN SEEDERS

29 | HANDTOOLS

31 | APPAREL & MISC

33 | TILMOR PHOTO CONTEST WINNERS



THE TILMOR POWER OX pg. 3



THE BASKET WEEDER pg. 9



TILMOR POWER OX

THE TWO-WHEEL TRACTOR

Conquer weeds and increase production with the Power Ox. Designed for planting, cultivation, and light hilling, the Power Ox is a great compliment for growers that already have primary tillage machines. One person can switch between implements by removing a single pin with no need for tools. Minimal assembly required.

STARTING AT \$2,300

FRAME WIDTH

Narrow	49-0201-N	\$2,300
--------	-----------	---------

WHEEL TYPE

Skinny - Knobby	49-4203	+\$0.00
Fat - Bar/Lug	49-4204	+\$100.00

**TWO WHEEL PACKAGES :
PAGE 15**

**ADD FRONT AND SIDE WEIGHTS:
PAGE 16**

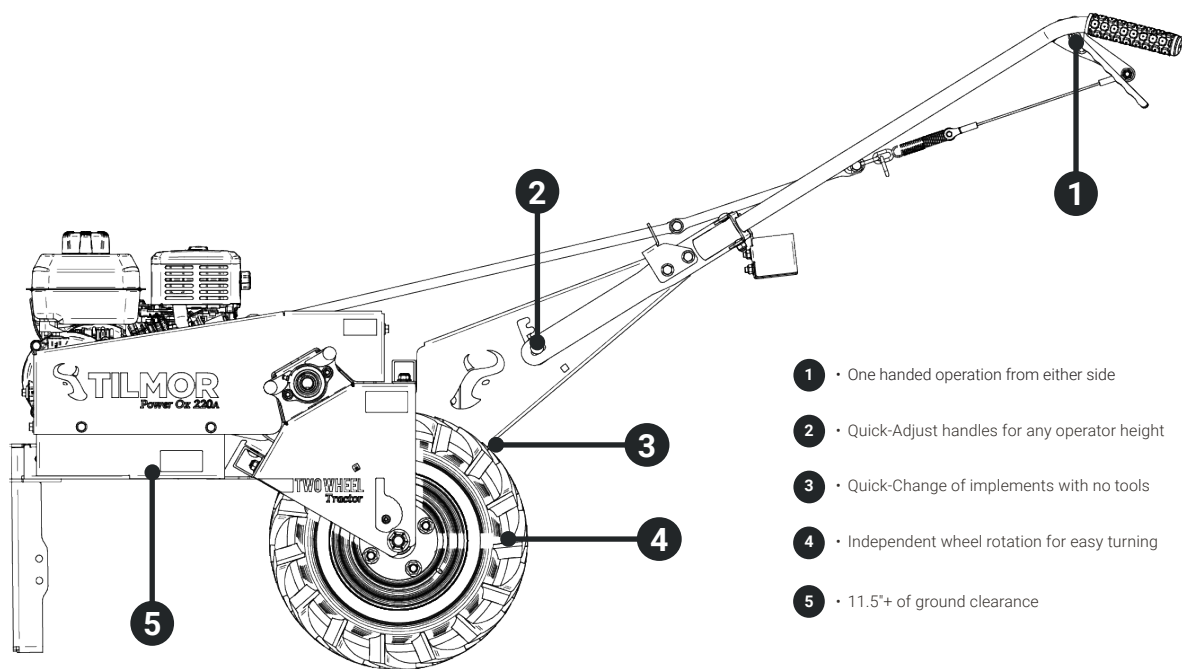

* Pricing and Specs subject to change



TILMOR TRACTOR

THE ULTIMATE ROW CROP TRACTOR

We, at Tilmor, are bringing back the art of cultivation with a vision for versatility and growth. The Tilmor 520 Series tractors are the ultimate row crop tractors for diversified farming operations and can be adapted to a multitude of crops and cultural practices. The Tilmor 520 Series tractors allow repeatable, predictable, profitable, and scale-able organic practices for growers to reduce manual labor and costly downtime.

DIESEL \$26,900

GAS \$24,500

FINANCING OPTIONS AVAILABLE

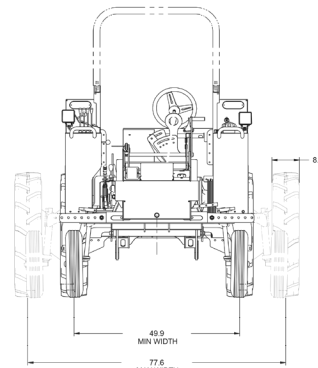
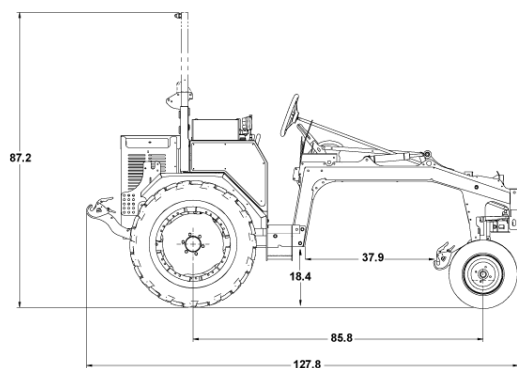

HORSEPOWER

22hp Kubota : Liquid-Cooled Diesel

21hp Briggs & Stratton Vanguard : Air-Cooled Gas

GROUND CLEARANCE (center working area)

18 inches (45.7 cm)

BRAKES

Hydraulic Disc Brakes

WHEEL ADJUSTMENTS (Center-to-Center)

50 - 78 inches (127 - 198 cm)

GROUND SPEED

1 - 13 mph (.5 - 21 kph)

TRACTOR WEIGHT

2700 pounds (1225 kg)

DRIVE SYSTEM

8-speed with reverse (Manual)

Synchronized 4-speed transmission with 2-speed high/low.

8 forward and 2 reverse



* Pricing and Specs subject to change



ACCURACY.

PRECISION.

REPETITION.

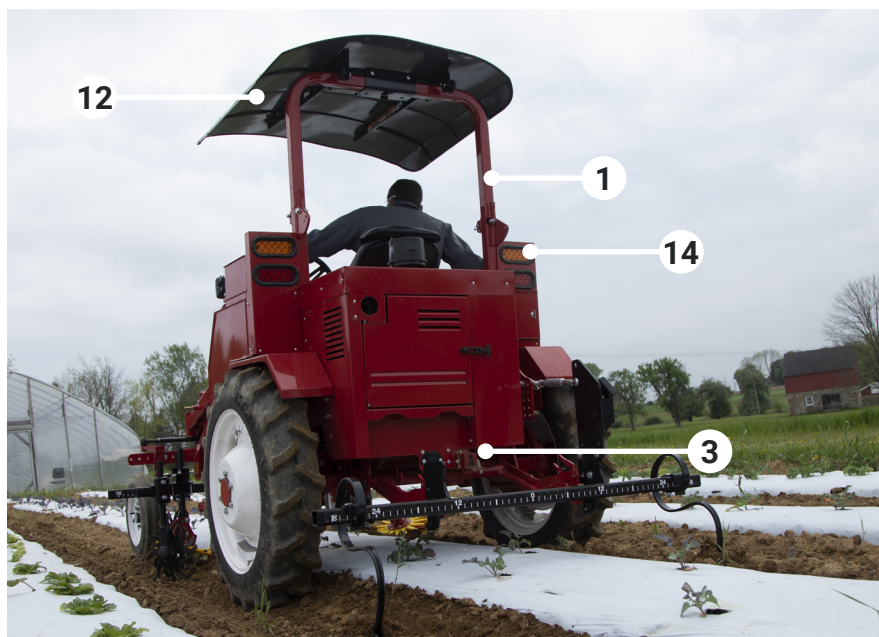

SAFETY FEATURES

- 1 • Standard fold down roll bar and seat belt
- Operator Safety Interlock System
- Shield and guards to cover critical heat and safety areas

CONVENIENCE

- 2 • Implement depth control for accuracy and easy depth setting
- 3 • Conveniently located 2" receiver tubes for easily modifying and customizing your tractor
- 4 • Operator's toolbox with USB port for charging your devices
- Ergonomic design

STANDARD FEATURES

- 5 • Front Toolbox
- 6 • Hydraulic lift/operation of mid and rear implements
- 7 • Front and Rear Wheel adjustments from 50" on center to 78" on center in 2" increments (per side)
- Synchronized manual transmission
- 8 • Automotive-style disk brakes on rear wheels. Separate brake pedals for sharp right or left turns.
- Automotive-style sealed electrical system
- 12V, 550CCA Battery

PREMIUM FEATURES

	• Cultivation Lights	Includes two 13" long LED lights mounted flush on each side of the front frame providing optimum working light for belly mounted implements. *Requires AT-9084	AT-9046	\$155
9	• Work Lights	Includes four LED 4" x 4" wide flood lights. Two forward and two rear facing lights located on the tractor fender. *Requires AT-9084	AT-9047	\$361
10	• Front Receiver Hitch	Bolt on kit for a front mount receiver hitch for 2" x 2" square tubing.	AT-9049	\$79
11	• Suspension Seat	Factory Install	AT-9054-99	\$583
12	• Tuff Top Canopy	Fold down canopy that bolts on ROPS.	AT-9059	\$371
	• Implement Hoist	Lift and Install implements onto front 3-pt. hitch of Tilmor tractor with ease. Includes pivot attachment for tractor. Load limit 450 lbs.	AT-9061	\$500
13	• Hoist Bracket Kit	Pair with Implement Hoist. Includes the arm bracket for lifting.	AA-9002	\$49
14	• Road Package	Includes amber and red marker/turn signal lights, two front head lights, horn, and slow moving vehicle (SMV) sign. *Requires AT-9084	AT-9077	\$472
	• Front Wiring Harness	Complete wiring harness for the front frame of the tractor. *Required for kits: AT-9046, AT-9047, AT-9077, AT-9088	AT-9084	\$71
	• Auxiliary Hydraulics	Add front and rear auxiliary hydraulic couplers to the tractor. Includes standard, female, 1/4" Quick-Connect couplers.	AT-9086	\$530
	• Aux Power - Front	Add a 4-pin, 40 amp, auxiliary electric outlet to the front of the tractor	AT-9088	\$85
	• Aux Power - Rear	Add a 4-pin, 40 amp, auxiliary electric outlet to the rear of the tractor	AT-9089	\$85
	• 12V Auxiliary Accessory Harness	Use this 4-pin plug and 10 ft wire to connect an accessory with the tractor's auxiliary power	32-0217	\$30

*Pricing and Specs subject to change





BASKET WEEDING

BASKET WEEDER ●●●

The Tilmor Basket Weeder is typically used for inter-row weeding. The wire baskets are spaced apart to allow for the crop row to pass between. Basket weeders may also be used to prepare a stale seedbed by placing the baskets together and running over the entire width of a seedbed.

FRAME SIZE

60-inch Frame	49-0050	\$179
80-inch Frame	49-0052	\$255

MOUNT

Cat. 1/Tilmor	60", 80"	\$117 - 144
Universal	60", 80"	\$117 - 153
Diamond Bar	80"	Call for Pricing

BASKET SIZE

4-inch Basket	AW-9004	\$141 (ea)
5-inch Basket	AW-9005	\$144 (ea)
6-inch Basket	AW-9006	\$146 (ea)
7-inch Basket	AW-9007	\$148 (ea)
8-inch Basket	AW-9008	\$150 (ea)
9-inch Basket	AW-9009	\$152 (ea)
10-inch Basket	AW-9010	\$154 (ea)
12-inch Basket	AW-9012	\$156 (ea)

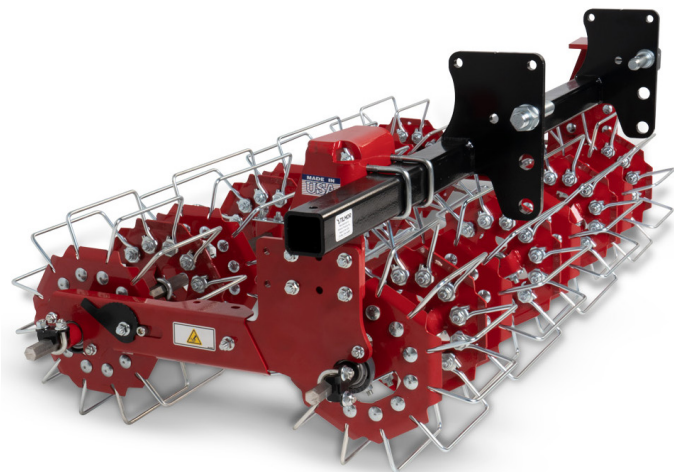

UPGRADE YOUR BASKET WEEDER!

MID-MOUNT TOOLBAR KIT ●●●



Mounting kit to install a 1.5" square toolbar to the middle of the basket weeder. Used with A-blades and 9" S-tines. The kit can be used for stale bedding and/or row marking.

AW-9070

\$43



1.5" TOOLBAR

This 1.5" Toolbar is designed to be used with the Mid-Mount Toolbar Kit. It has slots every 6 Inches for quick adjustments and a measuring tape can easily slip into the slots.

LENGTH

60 Inch	AW-1135	\$89
80 Inch	AW-1177	\$89

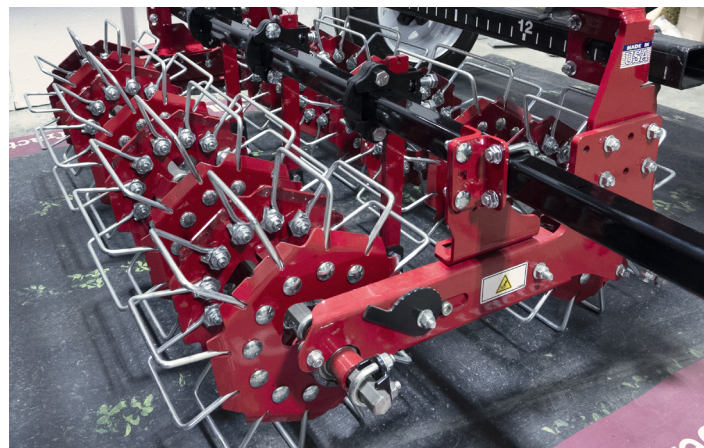

BASKET WEEDER WALK-BEHIND PACKAGE:

PAGE 15



TINE WEEDING

EINBOCK TINE WEEDER ●

Set yourself up for success with the Einbock tine weeder, specifically designed to uproot weeds in the 'white thread' stage. Its numerous adjustments allow for use in many different crops both in pre-emergence and post emergence stages. Adjusting the gauge wheels and tine angle allows the steel tine to 'dance' through the soil and around the crop while burying and 'flicking' out emerging weeds at the hair stage across the entire working width.

WIDTH

Aerostar 150 - 5ft	50015	\$3,295
Aerostar 200 - 6.5ft	50020	\$3,600
Aerostar 300 - 10ft	50030	\$4,795
Aerostar 450 - 15ft	51045	\$6,995
Aerostar 600 - 20ft	51060	\$8,400

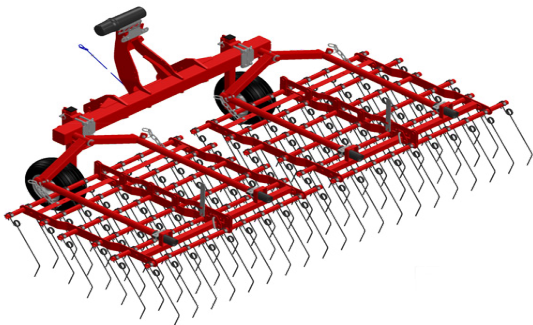

TILMOR EINBOCK TINE WEEDER KIT ●●

Einbock's proven tine weeder can conveniently be added to a Tilmor toolbar or can be purchased independently to go on a 2-inch toolbar of your choice.

INCLUDED IN PACKAGE

STARTING AT \$3,033

Einbock 5ft Tine Section	AA-9078	\$2,307
Gauge Wheels (2)	AW-9061	\$149 (ea)
2" Square Toolbar	49-0098, 49-0099	\$295
Height Adjust Clamp (2)	AA-9059	\$52 (ea)



TORSION WEEDER ●●●

The torsion weeder is perfect for uprooting weeds through shallow cultivation in the crop row.

- Good with loose soil
- Not suitable for heavy soil that is too hard
- Optimum weed stage: Cotyledon to 2-leaf
- Optimum Crop Size: Well-rooted crops until the crop canopies
- Suitable for most crops planted in rows with a row spacing of 10" and up

14" WIRE

1/4" Diameter-Right/Left Pair	49-0126	\$48
1/4" Diameter-Left	AW-3067	\$24
1/4" Diameter-Right	AW-3066	\$24

17" WIRE

5/16" Diameter-Right/Left Pair	49-0125	\$54
5/16" Diameter-Left	AW-3062	\$27
5/16" Diameter-Right	AW-3063	\$27



TORSION MOUNT ●●●

Mount for Left and/or Right Torsion Weeder Wires. Allows for adjustment of the pitch and angle of torsion wires for fine tuned weed control.

AA-9052

\$45

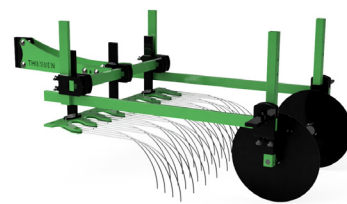

TINE WEEDER WALK-BEHIND PACKAGE:
PAGE 16

* Pricing and Specs subject to change



FINGER WEEDERS



FINGER WEEDER ●●●●

Specifically designed for in-row cultivation, the finger weeder uproots small and just emerging weeds. The ground engaging steel drive plate turns the flexible polyurethane fingers at a faster speed to "flick" out emerging weeds at the hair stage.

FINGER SIZE & HARDNESS

9 Inch Soft	AW-3072	\$163
9 Inch Medium	AW-3057	\$163
13 Inch Medium	AW-3011	\$169
13 Inch Hard	AW-3012	\$169
16 Inch Hard	Call For Pricing	

SHANK TYPE

Flat	AW-1140	\$16
Tool-Standard (Flat)	WB-TS350	\$16
Offset Flat	AW-1164	\$22
12" Modbar	AA-1094	\$23
18" Modbar	AA-1095	\$27
24" Modbar	AA-1096	\$34
37" Modbar	AA-1105	\$39



FINGER WEEDER REPLACEMENTS ●●●●

9-inch Soft, RED	AW-3072	\$36
9-inch Medium, YELLOW	AW-3057	\$36
13-inch Medium, YELLOW	AW-3011	\$42
13-inch Hard, ORANGE	AW-3012	\$42



EDGE OF PLASTIC FINGER WEEDER ●●●●

This finger weeder and round shank are designed specifically for the edge of plastic mulch or in any application where it is desirable to adjust the pitch of the fingers relative to the ground or rotate the head side to side.

FINGER WEEDER HUB	\$159
-------------------	-------

FINGER OPTIONS (choose up to 3 fingers)

13 Inch Medium	AW-3011	\$42 (ea)
13 Inch Hard	AW-3012	\$42 (ea)

SHANK

Round Shank	AA-9021	\$39
-------------	---------	------

ROW CROP FINGER WEEDER KIT



This row crop finger weeder kit can be added to most row crop cultivators with a max toolbar dimension of 7 inches. The unique trailing arm allows the operator to apply varying amounts of down pressure or lock the arm up depending on conditions or crop stage.

CALL FOR PRICING & AVAILABILITY

COMBINE FINGER WEEDERS WITH CLAMPS: PAGE 25



AA-9005



AA-9055
AA-9056



AA-9059
AA-9060

VINEYARD WEEDING : PAGE 19



FINGER WEEDER WALK-BEHIND PACKAGE: PAGE 15



SPYDERS & DISCS



HILLER DISCS ● ●

Efficiently create raised garden beds or hill your crops.

- Blanton style hub with 4 bolts and contains bearings to resist wear and tear
- Attach two disc bedders to toolbar to move soil efficiently in one pass
- 16" x 1-3/16" Round shank (Economy, Heavy Duty)

ECONOMY

12 inch Disc & Shank	AW-9071	\$46
14 inch Disc & Shank	AW-9072	\$50
16 inch Disc & Shank	AW-9073	\$57

HEAVY DUTY

Base Hub & Shank	AW-9030	\$103
12 inch Blade	79-0116	\$12.79
14 inch Blade	79-0115	\$12.79
16 inch Blade	79-0117	\$12.79



SPYDERS ● ●

Direct replacement Spyder wheels and assemblies for Bezzerides cultivators.

- Replaces disc hillers
- Mulches and aerates soil
- Leaves no "smooth shoulder" next to plants
- Conserves moisture
- Disc made of 1/4 inch long wearing, special steel
- 1-1/4" Round shank

HUB ASSEMBLY

Single on 1-1/4" shank	AW-9043	\$144
------------------------	---------	-------

SPYDER WHEELS

Left Hand	AW-1145	\$55
Right Hand	AW-1144	\$55



WALK-BEHIND HILLER DISC ●

Hiller discs are typically used in pairs to form ridges for a plant row, such as, hilling potatoes or peanuts. The angle and depth of the disc with respect to the row will affect how much soil is moved.

- Disc Size: 12 Inch
- Shank Specifications: 14" x 7/8"

12 Inch Disc	WB-DH305	\$86
--------------	----------	------



WALK-BEHIND 10" SPYDER ●

10" Spyder wheels and assemblies for 7/8" round shank clamps.

- Replaces disc hillers
- Mulches and aerates soil
- Leaves no "smooth shoulder" next to plants
- Conserves moisture
- Disc made of 1/4 inch long wearing, special steel
- 7/8" Round shank

10" Spyder Pair	AW-9062	\$149
-----------------	---------	-------

COMBINE HILLER DISCS, SPYDERS, & EDGE OF PLASTIC WEEDERS WITH ROUND SHANK CLAMPS: PAGE 25



AA-9025



AA-9033



WB-RSC



AA-9062



SPYDER REPLACEMENTS ● ●

Direct replacement Spyder wheels for Bezzerides cultivators.

ORIENTATION

Right	AW-1144	\$55.00
Left	AW-1145	\$55.00

* Pricing and Specs subject to change



S-TINES & SWEEPS



SWEEPS - VEGETABLE/BEET

S-tine mounted Sweeps combined with our Toolbars, ModBars, and Cross Clamps allow for cultivation in an almost infinite amount of conditions, row spacings, crops, and growth stages. Throws less soil than standard sweeps.

SWEEP SIZE

6" Sweep	AW-3100	\$10.69
8" Sweep	AW-3101	\$10.89
10" Sweep	AW-3102	\$11.19
12" Sweep	AW-3103	\$11.69
14" Sweep	AW-3104	\$14.69
16" Sweep	AW-3105	\$16.69



SWEEPS - STANDARD

S-tine mounted Sweeps combined with our Toolbars, ModBars, and Cross Clamps allow for cultivation in an almost infinite amount of conditions, row spacings, crops, and growth stages.

SWEEP SIZE

1" Reversible Point	AW-3083	\$3.19
2-3/4" Sweep	AW-3084	\$3.19
4" High Crown	AW-3085	\$4.19
4" Duck Foot	AW-3086	\$4.19
7" Low Crown	AW-3087	\$5.29
9" High Crown	AW-3088	\$5.69
10" High Crown	AW-3089	\$7.79



S-TINES

The vibrating action of S-tines create soil disturbance that mixes the top layer well, making it a great tool for eliminating weeds and incorporating soil amendments. The coiled spring alleviates shock when encountering obstacles and helps to extend the life of the toolbar and sweeps.

S-TINE SIZE

9" S-Tines	AW-3076	\$9.49
14-1/2" S-Tines	AW-3078	\$12.69
18-1/2" S-Tines	AW-3079	\$23

MOUNTING S-TINE/SWEEPS

Use 1.5" Clamps for 9" S-Tines and 2" Clamps for 14-1/2" S-Tines and 18-1/2" S-Tines.

1.5" Clamp	AA-9057	\$7.89
2" Clamp	AA-9048	\$6.89

BOLT PACK FOR S-TINE/SWEEPS

Each bolt pack contains six (6) 3/8" x 1-1/2" Elliptical Head Bolts & Nuts. One (1) bolt/nut is required to mount one (1) sweep to one (1) S-tine shank.

AW-3090

\$4.50

PARALLEL CULTIVATOR

Parallel Cultivators are designed to provide precise cultivation. Tilmor's parallel unit can be attached to any 2-inch square toolbar. The dual torsion springs allow for varying amounts of down pressure. The 1.5-inch modbars can be added to the parallel unit to attach tooling.

Additional components may be needed for customization.

COMPONENTS

Parallel Linkage Cultivator Kit	AC-9006	\$490
Parallel Linkage Front Mount Kit	AC-9008	\$45
8" Advance 1.5 to 1.5 Kit	AA-9079	\$42
8" Advance Flat Shank Kit	AA-9077	\$42
5" Advance 1.5 to 1.5	AA-9071	\$42
1.5" SQ Modbar 9"	AA-1246	\$21
Advance Mount Tube	AA-1231	\$19

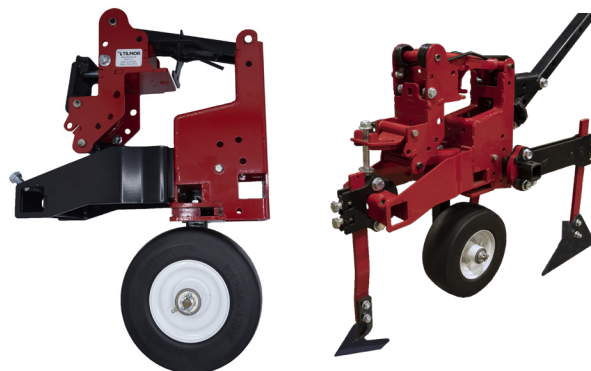

CALL TO CUSTOMIZE



VEGETABLE KNIVES



A-BLADES

A-Blades are a low profile sweep designed for shallow cultivation.

SIZE

4" Sweep	AW-6088	\$44
6" Sweep	AW-6087	\$46
8" Sweep	AW-6077	\$48
10" Sweep	AW-6086	\$51



CRESCENT HOE

These are designed for use on a universal straight shank with 2 slots adjustable for pitch. The crescent hoes feature a round turn shape which enables surgical precision cultivation on bed shoulders and ridges.

6" HOE

Right/Left Pair	49-0106	\$19
Right	AW-3049	\$9.29
Left	AW-3050	\$9.29



BEET/BEAN HOE

Beet hoes are designed for use on a universal straight shank with 2 slots for pitch adjustment. They create moderate disturbance in soil. Run them flat early in the season and later in the season reverse left and right and put the nose down and they will throw a significant amount of soil into the row.

7" HOE

Right/Left Pair	49-0101	\$28.30
Right	AW-3043	\$14.99
Left	AW-3044	\$14.99

9" HOE

Right/Left Pair	49-0102	\$33
Right	AW-3045	\$16.09
Left	AW-3046	\$16.09

13" HOE

Right/Left Pair	49-0103	\$44
Right	AW-3047	\$22
Left	AW-3048	\$22



TENDER PLANT HOE

The tender plant hoe is excellent at weed killing in shallow depths. They move little soil. Run flat early in the season and later in the season tilt the nose down to throw a minimal amount of soil into the row. Knives may also be used on the edges of plastic mulch.

7" HOE

Right/Left Pair	49-0104	\$28.58
Right	AW-3051	\$14.29
Left	AW-3052	\$14.29

9" HOE

Right/Left Pair	49-0105	\$34
Right	AW-3053	\$16.59
Left	AW-3054	\$16.59



FLEX TINE MOUNT

The Flex Tine Mount (or Flat Shank Flex Mount) mounts to a 2" square toolbar and allows for more independent movement of the arms and more flexibility in rocky conditions. Finger Weeder and other knives/blades with a rectangle shank of 3/8" x 1-3/8" profile will fit the Flex Tine Mount.

AA-9049 **\$52**

FLEX-TINE CLAMPS

AA-9048	2"	\$6.89
---------	----	--------

COMBINE VEGETABLE KNIVES AND A-BLADES WITH SHANKS AND CLAMPS: PAGE 25



AW-1164



AW-1140



AW-9021

All A-Blades and Vegetable Knives fit shanks that require two 3/8 x 1-1/4" Carriage Bolts

* Pricing and Specs subject to change



TWO-WHEEL TRACTOR

BASKET WEEDER

The Tilmor Basket Weeder is typically used for inter-row weeding. The wire baskets are spaced apart to allow for the crop row to pass between. Basket weeders may also be used to prepare a stale seedbed by placing the baskets together and running over the entire width of a seedbed.

INCLUDED IN PACKAGE		STARTING AT \$1,253
35-inch Axle	49-4071	\$80
Toolbar Mount	AU-9007	\$67
24" ModBar	AU-1096	\$34
7" Basket (4)	AW-9007	\$148 (ea)



USE WALK BEHIND TOOLS ON BCS AND GRILLO TRACTORS!

BCS ADAPTOR

With this adaptor, many Theissen and Tilmor implements can be used on a variety of power units with a simple pin hitch attachment. Male Quick Couplings Required.

PA-9057

Call for Pricing



FINGER WEEDER AND TENDER PLANT HOE-1 ROW

Perfect for performing a single cultivation pass on each crop row while doing both in row and between row cultivation. Intended for single row spacing of 15 inches or more.

INCLUDED IN PACKAGE		STARTING AT \$1,061.08
7" Tender Plant Hoe-Pair	49-0104	\$28.58 (ea)
13 Inch Finger and Hub (2)	AW-9003	\$169 (ea)
Flat Shank Tool Standards (4)	WB-TS350	\$16 (ea)
Standard Cross Clamp (10)	WB-SCC	\$20 (ea)
21" Crossbar	WB-TA760	\$22 (ea)
Trailing Arms-Pair	WB-PJAGW	\$57 (ea)
21" Toolbar	WB-PJ535	\$137 (ea)
Adjustable Gauge Wheel (2)	WB-PJAGW	\$105 (ea)
Bolt/Hardware Pack (1)	49-4072	\$4.50 (ea)





PATHWAY CULTIVATOR

This cultivator set-up is ideal for tilling soil the entire span of the pathway width. Customization for smaller or larger paths is available online or by phone. Recommended overlap between sweeps is 1" to 2" for full coverage.

INCLUDED IN PACKAGE		STARTING AT \$721.35
1.5" Toolbar for Power Ox	AU-9007	\$67
18" Modbar - 1.5" SQ tube (2)	AA-1095	\$27 (ea)
24" Modbar - 1.5" SQ tube (2)	AA-1096	\$34 (ea)
1.5" Square Cross Clamp (4)	AA-9038	\$31 (ea)
9" S-Tine (5)	AW-3076	\$9.49 (ea)
1.5" S-Tine Clamp (5)	AA-9057	\$7.89 (ea)
6" Vegetable Sweeps (5)	AW-3100	\$10.69 (ea)
Adjustable Gauge Wheel (2)	WB-PJAGW	\$ 105 (ea)
Gauge Wheel Clamp (2)	AA-9063	\$29 (ea)



**3-ROW CULTIVATION
PACKAGES AVAILABLE**

TINE/WIRE WEEDER

Tine sections are available in two widths, 6" and 9". You can stack them together to make any width from 6 to 63" in 3" increments. Plates are reversible to allow trash flow to the left or to the right and the non-welded design makes the tines easy to remove or replace.

Important: A hitch, trailing arm (pair), gauge wheel (pair), and a minimum of three (when using fixed gauge wheels) or five (when using adjustable gauge wheels) cross clamps are required to mount one tine weeder section. Every additional tine weeder section requires an additional cross clamp.

SECTION WIDTH

6" Section	PA-9023	\$75
9" Section	PA-9024	\$89

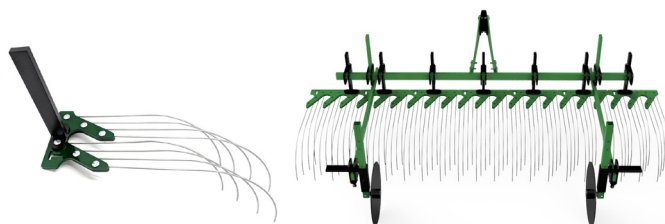

FRONT WEIGHT KIT

Front Weight kit for use on the Tilmor Power Ox.

Each kit includes four lasered plates weighing 5lbs each and a 5/8" hitch pin to secure to the power unit.

Use with heavier implements to provide counterbalance for easier lifting of implement.

AU-9004

\$75



SIDE WEIGHT KIT

Side Weight kit for use on the Tilmor Power Ox.

Each kit includes a weight holder that bolts on top of the wheel fenders, four lasered plates weighing 5lbs each and a 5/8" hitch pin to secure the weights to the weight holder.

Use if you find more traction is needed when operating heavy ground engaging attachments on heavy or compacted soil. **One weight kit required for each wheel.**

AU-9003

\$98

* Pricing and Specs subject to change



FARMER'S SPOTLIGHT

KRISTEN BAUGHMAN

➤ OF CURLY GIRL FARM ➤

From the time that she was young, Kristen Baughman, also known as Curly Girl, found herself in the fields. At the age of thirteen, she started working as a farm hand, and this job continued through high school and college. As her love for farming grew, Kristen set her passion into motion and started her own farm.

Curly Girl Farm is rooted in Zanesville, Ohio, where Kristen lives in a historic 1848 home. Her interest in history and her creative nature transformed the farm into a unique operation for heirloom vegetables and aesthetic market stands. A three-acre plot next to her home is where the majority of the growing happens,

including leafy greens, green beans, cucumbers, zucchini, bell peppers, eggplant, sweet corn, squash, and tomatoes. She also produces vegetables on two to three acres of land off of the property.

Beyond vegetables, Kristen has a flower patch full of sunflowers, dahlias, celosia, and zinnias, just to name a few. She hosts "Cut Your Own" events when the flowers are in season, where people come to Curly Girl Farm, pick and cut their own flowers from the patch, and assemble them into a bouquet. At these events, Kristen treats her guests to appetizers with ingredients grown on her farm.



No matter what she grows, Kristen keeps her produce free of synthetic fertilizers, pesticides, and herbicides. This is a wonderful benefit for consumers, but it does not come without cost for Kristen as keeping her crops weed-free can become a full-time job.

With the help of a part-time farm hand who works in the garden and her mom and aunts who take turns selling produce at farmers markets, Kristen plants, weeds, picks, and sells her products locally. This is no small task to tackle, especially with limited time and equipment.

In 2017, Kristen attended the Tilmor Mechanical Weed Control field day and learned various ways to improve her already successful farm. Through this event, Kristen learned that purchasing an Allis-Chalmers tractor would greatly benefit her, and that is exactly what she did. Coupled with her purchase of the Tilmor Basket Weeder and Finger Weeder, Kristen walked away with the ability to significantly decrease the time and effort necessary to weed her fields.

Now, with the help of mechanical equipment, the weeding process on Curly Girl Farm is more efficient, and Kristen is able to give more of her attention to harvesting her products and transporting them to the markets.

Kristen's passion and the fresh produce that results from it stretches beyond Curly Girl Farm. She is also involved in Urban Greens, a program based in Muskingum County that works to grow urban agriculture, developing community gardens and providing agricultural education for locals.

There is no doubt that Kristen's days are full, but they are equally rewarding. She says, "I'm always amazed when I look around and think my hands produced all of this and I picked all of this. Yeah, it's worth it."

Tilmor is grateful to know Kristen and appreciates the example that she sets of commitment and service!



VINEYARD WEEDING

ADAPTIVE CULTIVATOR SYSTEM

The adaptive cultivator system is a weed control tool for vineyards, trellised orchards, hemp and fence lines.

Using a 26" finger weeder head supported by a flexible torsion arm it requires no electronic or hydraulic input as it works to eliminate weeds in the crop row without damaging the established crop. The fingers are able to run right up to, and around the crop without operator input and does not leave an unworked area like a radius on a grape hoe and the machine excels at working speeds of 4-7mph depending on soil and crop conditions.

Running ahead of the finger weeders are a gang of spyders that work to control weeds alongside the row. Depending on how they are set, they can also be used to move a small amount of soil towards or away from the crop row. These spiders also run on a flexible torsion mount which allows them to adjust to contours on the ground without operator input. A rigid guard designed to deflect vines, trees or other crops protects both the crop and the equipment from damage.

The 80 durometer (yellow) finger weeder head is not recommended for peaches or other trees with exceptionally soft bark, especially when they are young.

2" square tube toolbar or existing 2" square bar-mount required for use.



STARTING AT \$3,572

Adaptive Cultivator Head	49-0221	\$789
Adaptive Cultivator Frame	49-0220	\$2,783
Replacement Finger Section - 26" Yellow	AW-3110	\$69

SPYDER ORIENTATION

Right	PA-9030	\$265
Left	PA-9029	\$265

2" SQUARE TOOLBAR :
PAGE 24





MOUNTING & UNDERCUTTERS

MOUNTING SYSTEMS



SIDE LIFT

The Thiesen Side Lift is designed to mount between the front and rear wheels of a tractor to provide a side mounting and lifting location for cultivation tools such as the Adaptive Cultivation System or disc hillers. With 16 inches of vertical travel, it provides a convenient way to mount tooling in one of the best locations for control and visibility of equipment.

The side lift will require a custom mounting solution to attach it to the tractor, as well as hydraulic lines of the appropriate length and a single remote valve, but includes the lift cylinder, as well as 2-inch mount for tooling that can be located in a variety of positions.

SM-400-tc

Call for Pricing

ADJUSTABLE TOOLBAR

Designed to be mounted to either a Category I or II rear 3-point hitch, as well as 3 point front hitches. The toolbar can adjust from a width of 1.2m (48") to 2.2m (88") and can carry a variety of tooling from the Adaptive Cultivation System to disc hillers and weed sprayer booms. The included cylinders are plumbed to move together with a single remote valve on the tractor. They can be separated for independent operation.

Gauge wheels can be added for a more consistent depth control.

AT-1200

\$2,703



BEDLIFTER/UNDERCUTTER

Ideal for loosening the soil for harvesting carrots, garlic, parsnips and other root crops.

Use up to 350# (42" Undercutter) and up to 500# (48" Undercutter) on the toolbar to help the undercutter pull down into the soil.

CUTTING WIDTH

35 Inch	PA-9034	\$795
42 Inch	PA-9021	\$1055
48 Inch	PA-9022	\$1,289



WEIGHTS : PAGE 23

*Pricing and Specs subject to change



PLASTIC MULCH LAYING & REMOVAL

PLASTIC MULCH LAYER

The Tilmor plastic layer is a modular design for laying 3' and 4' plastic and up to two rows of standard drip tape. The innovative design includes the following features:

- Holds up to two rolls of the plastic drip tape
- Built in carrier for second role of plastic mulch
- Adjustable bed shaper for laying 1 meter, 3' and 4' plastic mulch
- Max. diameter of plastic rolls: 9-1/4"
- No tools required, easy adjustment for tire tension and closing discs
- Integrated holder for carrying a standard ground shovel
- One drip tape trencher AB-9011

• Optional Plastic Mulch: 1 mil., black, 48" wide, 2,400' long, diamond embossed
For proper use it is required to mound up the bed area with hiller discs before using the plastic layer. This package does not include hiller discs.



Plastic Layer	AB-9010	\$2,544
Category 1 - 64 inch	49-0096	\$324
Tilmor - 64 inch	49-4098	\$295
Additional Drip Tape Roller Mount	AB-9011	\$30 (ea)
Optional Plastic Mulch	PA-9060	\$77 (ea)



PLASTIC WINDER

The ground driven reel allows for consistent tension on the plastic at any speed. No more adjusting the ground speed to reel speed!

The unique belt drive spins the reel backwards which helps shed the majority of dirt and plant debris. This keeps organic matter on your farm, not in the landfill.

The plastic winder is able to wrap up to 600' of 4' plastic at a typical collection speed between 3/4 - 3 mph.

For best results, keep the edge of your plastic weed free and mow off any tall or bulky crop residues and wrap drip tape with the plastic mulch.

This requires the Plastic Lifter or alternative lifting system and a 2" toolbar for installation and operation.

48-11400

\$2,700



PLASTIC LIFTER

Two 20" notched blades gently cut underneath and lift the plastic. The blades can be easily attached to a 2" toolbar via U-bolts for maximum adjustability.

It can be used on 4' and 5' wide plastic.

49-0053

\$800



PLASTIC LIFTER/WINDER COMBO

The Plastic Lifter and Winder system will allow you to lift and wind plastic at the same time on standard 3" to 4" raised beds. Taller beds may require separate lifting and winding operations.

This system can be used on low horsepower tractors down to 20 horsepower.

The lifter has a wide adjustment range, allowing you to fit the width of your plastic (3 ft., 4 ft. or 5 ft.). The plastic winder is ground driven, meaning that whatever speed you're traveling, the winder is spinning appropriately. The winder also spins in a direction that allows for dirt and debris to be shed from the plastic as it winds.

49-0224

\$4,513



* Pricing and Specs subject to change

TOOLBARS, MODBARS & MORE



TOOLBARS FOR POWER OX/ PLANET JR/SIMPLICITY/ WATERLOO •

Standard toolbar fits both original Planet Jr B series tractors as well as the Power Ox.

Upgraded front hitch will allow it to attach to a Simplicity or Waterloo tractor as well.

Bolt together design allows for flatter packing, as well as two different lengths. Toolbar is made of 5/8x1-1/4 steel.

TOOLBAR SIZE

21 Inch	WB-PJ535	\$137
27 Inch	WB-PJ685	\$148
52 Inch	WB-PJ1320	\$172

TOOLBAR ADD-ONS

Simplicity/Waterloo Hitch Upgrade	WB-SWH	\$26
-----------------------------------	--------	------



GAUGE WHEELS •

Improve your depth control and implement tracking with a pair of gauge wheels. Gauge wheels are recommended for most cultivation setups.

WHEEL TYPE

Adjustable	WB-PJAGW	\$210
Fixed	WB-FGW	\$149



GAUGE WHEEL CLAMP •

• Clamps Thiessen Tillage Equipment Adjustable Gauge Wheels to 1.5" Square Toolbars.

AA-9063	1.5"	\$29
---------	------	------



CROSS BARS •

Allows for a second row of tooling on a toolbar. Typically attached to the trailing arms using the standard cross clamps. If needed a third row could be added as well, although this will make the cultivator quite heavy.

BAR LENGTH

21 Inch	WB-CB535	\$22
27 Inch	WB-CB685	\$26

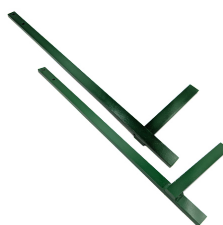

TRAILING ARMS •

30" long with a 10" leg used in most cultivator setups. Typically, the shorter leg will be attached to the main toolbar, with gauge wheels attached at the back of the trailing arms and a cross bar in the center if additional tooling that will not fit on the main hitch is needed. Sold in a pair.

WB-TA760	\$57
----------	------



TRAILING ARM MOUNT • •

The Trailing Arm Mount provides a simple way to stack tools and add flotation for cultivation implements.

Stacking tools allows for more effective weed control.

Flotation is important when cultivating multiple rows and/or uneven ground to provide optimal ground contact for implements such as Finger Weeders and Vegetable Knives.

Adjust the desired amount of downward pressure by changing the tension on the torsion springs.

AW-9044	\$140
---------	-------



MID-HITCH •

Used mostly commonly in conjunction with the wide 52" toolbar, this kit allows you to mount tooling for the center row, offset back from the outer two rows. Clamps, instead of a welded hitch, allow for adjustment of the spacing between the forward bars to accommodate different types of tooling. Includes two Standard Cross clamps, two 14" legs and one 18" hitch.

WB-MH460	\$57
----------	------



44LB/20KG WEIGHT WITH LATCH • •

The Tilmor 44 pound suitcase weight is designed to conveniently hang on any standard 2" square tube. The spring loaded safety latch ensures the weight remains on the toolbar even in rough terrain. This unique weight can be used with any 2" toolbar or serve as a tractor weight.

AT-9001	\$74
---------	------



TOOLBAR FOR POWER OX/ PLANET JR. FOR 1.5" TUBE ●

Designed to fit the single pin implement system that is used on Planet Jr. and Power Ox two-wheel tractors. Bolts on to a 1.5" square tube. **1.5" Modbar Not Included**

AU-9007

\$67



MODBARS

1.5" SQUARE MODBAR

12", 18", 24", 37" ● AA-1094, AA-1095, \$23 - \$39
AA-1096, AA-1105

2" SQUARE MODBAR

12", 18", 24" ●● AA-1079, AA-1080, \$25 - \$32
AA-1081



ALLIS CHALMERS G FRAME EXTENSION AND TOOLBOX

The Allis Chalmers G 12" extension by Thiessen Tillage Equipment will give additional tooling options for your Allis G by adding more mid-mount space.

ACG-X305

12" Extension

\$279



GAUGE WHEEL ●●

Gauge Wheels can be very helpful for allowing rear mounted toolbars to float with the ground terrain and keep tools at a constant depth. Use with AA-9059 Kit, Height Adjust Clamp. A pair of Gauge Wheels and Height Adjustment Clamps are recommended for use with rear mounted Plastic Lifter.

AW-9061

\$149



JACK STAND WITH MOUNT ●●

Add a jack stand to your 2" toolbar to aid in installation, removal, and storage of implements.

AA-9034

\$85

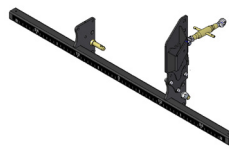

TILMOR TOOLBAR ●

64", 76"

49-0098, 49-0099

\$295



FARMALL TOOLBAR

64", 76"

49-0092, 49-0093

\$322

DIY Mount Kit

49-4103

\$179



ALLIS-CHALMERS G TOOLBAR

64", 76"

49-0090, 49-0091

\$295

DIY Mount Kit

49-4102

\$149



KUBOTA L245 TOOLBAR

64", 76"

49-0094, 49-0095

\$265

DIY Mount Kit

AA-9040

\$122



CATEGORY 1 TOOLBAR ●

64", 76"

49-0096, 49-0097

\$324



2" SQUARE TOOLBAR ●●

64", 76"

49-4100, 49-4101

\$143

**DIY MOUNT KITS SOLD SEPERATELY FOR IF YOU
ALREADY HAVE A 2" SQUARE TOOLBAR**

* Pricing and Specs subject to change



SHANKS & CLAMPS



FLAT SHANK MOUNT

Mounting option for use with Finger Weeders, Vegetable Knives and A-Blades. Dimensions: 13.56" x 1.19" x .375" with a .44" offset where the implement mounts.

AW-1164 ● ● \$16



OFFSET FLAT SHANK MOUNT

Mounting option for use with Finger Weeders, Vegetable Knives and A-Blades. Dimensions: 13.56" x 1.19" x .375"

AW-1140 ● ● \$22



FLAT SHANK CLAMP

- Clamps a flat bar (3/8" x 1-3/8" profile) to a 2" square tube.
- One adjustment bolt secures both horizontal movement of the clamp and vertical movement of the shank.
- Adjustment bolt and nut are easily replaceable when worn.
- Adjustment bolt pushes against a flat plate to protect toolbar from damage.

AA-9005 ● ● ● 2" \$29



FLAT SHANK CLAMP

- Clamps a flat bar (3/8" x 1-3/8" profile) to a 1.5" or 2" square tube.

AA-9055 ● 1.5" \$35

AA-9056 ● ● 2" \$37



FLEX TINE MOUNT

The Flex Tine Mount (or Flat Shank Flex Mount) mounts to a 2" square toolbar and allows for more independent movement of the arms and more flexibility in rocky conditions. Finger Weeders and other knives/blades with a rectangle shank of 3/8" x 1-3/8" profile will fit the Flex Tine Mount.

AA-9049 ● ● \$52

FLEX-TINE CLAMPS

AA-9048 ● ● 2" \$6.89



ROUND SHANK 1-1/4"

1-1/4" Round shank with included hardware for mounting vegetable knives and Edge of Plastic Finger Weeder. Two holes in mounting plate are made for 3/8" carriage bolts, 1-13/16" center-to-center separation.

Shank Length: 23.44"

AW-9021 ● ● 1-1/4" \$39



ROUND SHANK CLAMP: ECONOMY

- Clamps a 1-1/4" round shank to a 2" square tube
- Fabricated plate with U-bolts

AA-9025 ● ● 2" \$29



ROUND SHANK CLAMP: QUICK-SET STANDARD

- Clamps a 1-1/4" round shank to a 2" square toolbar.
- Easy adjustment of tools and spacing for growers needing to adapt to various crops and conditions.

AA-9033 ● ● 2" \$69



SQUARE TUBE CROSS CLAMP

- Clamps a 1.5/2" square tube to a 1.5/2" square tube
- Convenient solution for connecting two square tubes.

AA-9029 ● ● 2" to 2" \$31

AA-9038 ● 1.5" to 1.5" \$30



TOOL STANDARD (7/8" ROUND SHANK)

Combine with 7/8" round shank clamps to allow rotational movement of tooling such as vegetable knives and hilling tools.

Thiessen 7/8" ●	PA-9025	\$17
Tilmor 7/8" ●	AW-6069	\$15.89



TOOL STANDARD (FLAT SHANK)

Mount vegetable knives or finger weeder onto toolbars.

Dimensions: 1/2" x 1-1/4" x 13-3/4"

Requires Thiessen or Planet Jr. style clamps.

WB-TS350 ●	\$16
-------------------	-------------



ROUND SHANK CLAMP

- Clamps a 7/8" diameter round shank standard to 1/2-5/8 x 1-1/4" flat toolbar.
- Pair with walk-behind hiller discs, spyders, etc.

WB-RSC ●	\$21
-----------------	-------------



PLANET JR FLAT SHANK CLAMP

- Clamps various components to Thiessen toolbars including gauge wheels, trailing arms, cross bars and tooling.

WB-SCC ●	Standard Cross	\$20
WB-CMC ●	Center Mount	\$22



ROUND SHANK CLAMP

- Clamps a 7/8" round shank to a 1.5" square toolbar.
- Two bolts secure both horizontal movement of the clamp and vertical movement of the shaft.
- With its unique design, this clamp can be removed or added to a toolbar without having to remove additional tooling on the toolbar. It can also be positioned between two welded pieces on a toolbar.

AA-9062 ●	1.5"	\$37
------------------	-------------	-------------

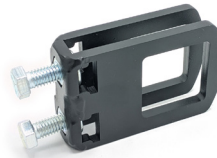

FLAT BAR TO 1.5" CROSS CLAMP

- Clamps a flat bar (1/2" x 1-1/4") to 1.5" square tubing.

WB-SQC ●	1.5"	\$21
-----------------	-------------	-------------



SQUARE TUBE CROSS CLAMP

- Clamps a 1.5"/2" square tube to a 1.5"/2" square tube
- Convenient to adjust
- Robust for a variety of agricultural applications

AA-9082 ● ●	2" to 2"	\$45
AA-9083 ●	1.5" to 1.5"	\$36
AA-9084 ● ● ●	2" to 1.5"	\$41



HEIGHT ADJUST CLAMP

- Mounts to a 2" Square toolbar and allows installation of tools and implements that use a 1.5" or 2" square tube such as finger weeder or gauge wheels.

AA-9059 ● ●	2" to 2"	\$52
AA-9060 ● ●	2" to 1.5"	\$48

* Pricing and Specs subject to change



SEEDERS

JANG FOR TRACTOR

This one row mountable Jang is a simple solution for s consistent, and accurate seeding. Seed rollers are easy to change and adjust.

- Mounts to 2" Square Toolbar, no tools required
- Max. recommended planting speed: 1.7 mph
- Spring loaded scissor hitch with approx. 3" of float
- Quick release hopper
- Clear, durable plastic hopper to view seed level
- Hopper volume = 0.26 gal
- Adjustable depth control
- Singulates and spaces small seeds; saving time and money
- Seed sizing gauge on hopper lid for ease of roller selection
- Uses special anti-static plastic rollers to prevent seeds from clinging
- Weighs 30 lbs.

JPH-U **One Row** **\$998**



JANG SEEDER - PUSH

The Jang one row push seeder is a simple solution for a consistent, and accurate seeding. Seed rollers are easy to change and adjust.

- Adjustable handle for both height and offset
- Quick release hopper
- Clear, durable plastic hopper to view seed level
- Hopper volume = 0.26 gal
- Adjustable depth control
- Singulates and spaces small seeds; saving time and money
- Seed sizing gauge on hopper lid for ease of roller selection
- Uses special anti-static plastic rollers to prevent seeds from clinging
- Weighs 25 lbs.

JP-1 **One Row** **\$440**



SEED ROLLERS

Each seeder includes one seed roller of any size, and each additional roller is \$30. Call or visit Tilmor.com to learn more about what seed roller works best for your operation.

Seed Roller	Cell Size	Cells Per Wheel
Y-12	3.5mm / .14in	12
X-12	4mm / .16in	12
R-12	9mm / .35in	12
J-12	5mm x 11mm / .20in x .43in	12
N-6	9mm x 16mm / .35in x .63in	6
M-12	5.5mm / .22in	12
F-12	5mm / .20in	12
L-12	7mm / .28in	12
S-4	14mm x 20mm / .55 x .79	4



CLEAN SEEDER - PUSH

This clean seeder is a single-line push planter. It's suitable for planting all types of small seeds including vegetables, herbs and flowers.

- Includes one seed roller
- Includes a modified chromium planter shoe

Clean Seeder AP1	One Row	\$350
------------------	---------	-------



Seed Roller	Cell Size	Cells Per Wheel
X-24	4mm / .16in	24
F-24	5mm / .20in	24
Y-24	3.5mm / .14in	24
MM-12	6mm / .24in	12
G-12	9mm / .35in deep	12
Q-12	8mm / .31in	12
A-6	13.5mm / .53in	6
AA-12	12mm / .47in	12
A-12	13.5mm / .53in	12
XL-12	6mm / .24in	12
G-24	9mm / .35in deep	24

CLEAN SEEDER FOR TRACTOR

This clean seeder is a single-line toolbar mounted planter. It's suitable for planting all types of small seeds including vegetables, herbs and flowers. Additional Seeders can be purchased and attached to same toolbar to plant more than one row.

- Includes one seed roller
- Includes a modified chromium planter shoe
- Mounts to a 2" square toolbar

Clean Seeder APTB	One Row	\$825
-------------------	---------	-------

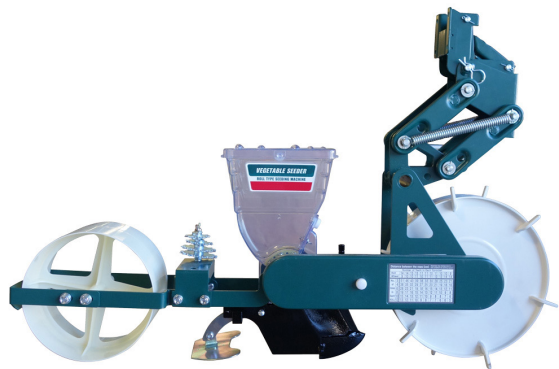

SEED ROLLERS



MODIFIED CHROMIUM PLANTER SHOE

* Pricing and Specs subject to change



HANDTOOLS

HAND DIBBLER

Dibbler Length	
12 Inch - Wood	\$28
20.5 Inch - Wood	\$30
60 Inch - Aluminum	Includes Adapter and Point \$50



DIBBLER WHEEL

Leaves an impression in the soil to accurately space transplants. Pokes accurate holes in plastic also!

- Plant spacing of: 3", 4", 6", 8", 12", 15", 22", and 41"
- Moisture resistant, wooden wheel (Advantech Flooring) - Plastic wheel option!
- Coated only with linseed oil
- 2-inch wide plastic outer wheel - Now standard!
- CAD designed and CNC cut inner wheel spokes for strength and functionality
- Red powder coat finish on steel
- Dibbles are 7075 (hard) aluminum 2 1/2" long, 1" diameter

Single Dibbler		\$230
Infinite Dibbler (2 wheels)	Up to 32" row spacing	\$410
Additional wheel	Add to Infinite dibbler	\$130

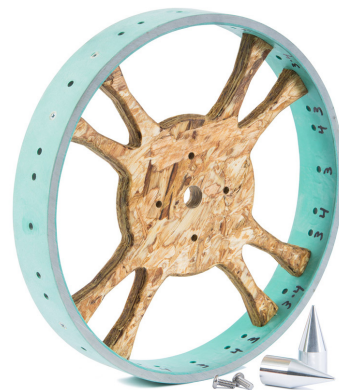
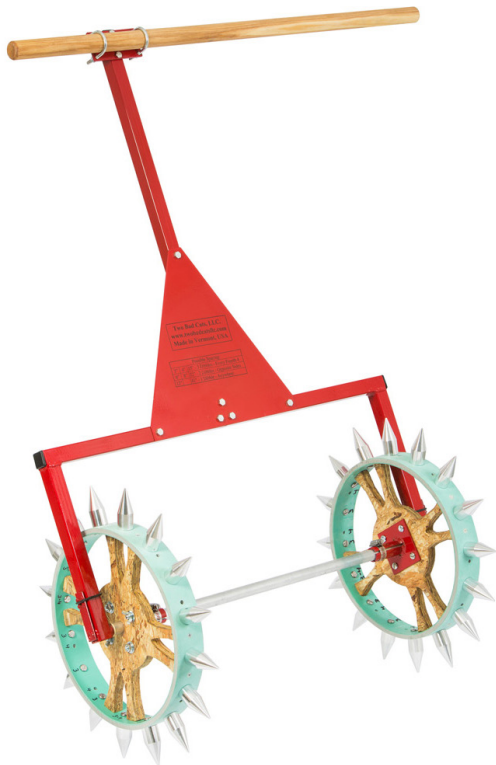



ROTOVATOR

The Pioneer Rotovator allows you to hear the birds, smell the soil and feel the gentle pull of the tines as you till your garden or produce patch. The crumbler wheel breaks up the soil while the rear tines cultivate. Use inverted and the double edged blade will cut any weeds, leaving a neatly tilled surface.

62001100

\$222



TINE WEEDER - 30"

Sometimes called a blind weeder. White thread stage tine weeder. For when your plants are established and weeds are not! Spring tines will go around your established plants and pull out white thread stage weeds. Quickly maintain you beds by dragging this through once or twice a week. Lightweight! Great for high tunnels. Save time by not pulling up drip tape! Sometimes requires 2 passes for optimum weed control. Each tine is 3" from it's next neighbor. Two offset rows equals 1 1/2" between tines.

852229002330

\$260

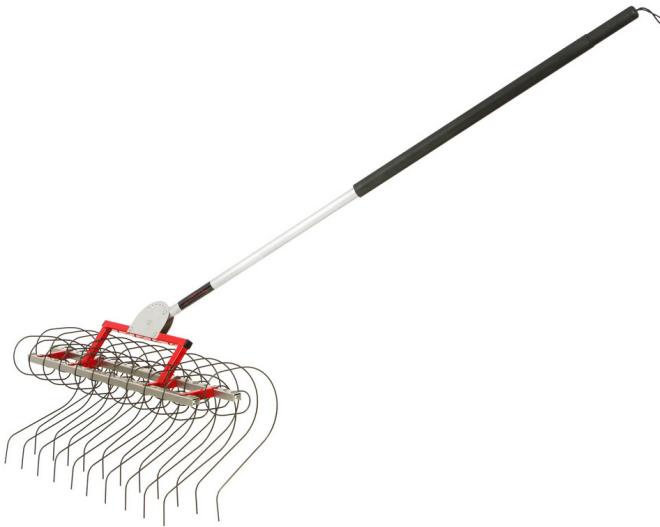

WIRE WEEDER

HANDLE LENGTH	WIRE TYPE	
14 Inch	Flat, Single Flat, Double Flat	\$35
60 Inch	Flat, Single Flat, Double Flat	\$55
73 Inch	Flat, Single Flat, Double Flat	\$65



* Pricing and Specs subject to change



APPAREL & MISC

TILMOR TRI-BLEND TEE

- Water-based ink on this Canvas tri-blend tee gives it a soft, comfortable feel to make it an everyday favorite.
- 50% polyester, 25% combed and ring-spun cotton, 25% rayon.
 - Side-seamed.
 - Unisex fit.
 - Various color options.



ADULT T-SHIRT

White Fleck	S-XXL	\$13
Lilac	S-XXL	\$13
Grey	S-XXL	\$13
Clay	S-XXL	\$13

YOUTH T-SHIRT

Red	YS-YL	\$13
Peach	YS-YL	\$13
Blue	YS-YL	\$13

TILMOR RINGER TEE

Contrast trim adds a splash of color to this heathered classic men's Canvas ringer tee. 52% combed and ring-spun cotton 48% polyester.

BROWN	S-XXL	\$13
--------------	--------------	-------------



BELTS

These Minimalist Belts from GRIP6 are perfect for any occasion.

- 100% Made in the USA
- Interchangeable buckles and straps
- Simple, lightweight, and comfortable belts
- Low profile belt
- No-slip locking mechanism
- High grade materials
- Only belt with no holes & no flap

BUCKLE

Black	Full Logo or Ox	\$15
Blue	Full Logo or Ox	\$15
Gunmetal	Full Logo or Ox	\$15

STRAP

Black	\$13
Gray	\$13
Mocha	\$13



6-3/4" ANGLE NOSE SLIP

Gripped and Polished with Shear/Wire Cutter.

Jaws are milled with deep, self-gripping pipe wrench style teeth and bolts are hardened.

Often called "Battery Pliers"

09-T-T001	\$12
------------------	-------------



TILMOR HATS

Slay your weeds in style with a Tilmor hat!

COLOR

Black	09-T-H002	\$13
Heather Grey	09-T-H003	\$13
Khaki Brown	09-T-H001	\$12



TILMOR LEATHER PATCH BEANIES

Wear on the coldest days and on the everyday.

COLOR

Heather Black with Cuff	09-T-H004	\$22
Birch Waffle Knit	09-T-H005	\$22
Rust Waffle Knit	09-T-H006	\$22



TILMOR POCKET KNIFE

This serrated Tilmor pocket knife is great of everyday use on any operation! Nine colors to choose from!

Featuring a convenient ruler on its blade and a clip to carry on your belt.

09-T-T002	\$7.50
------------------	---------------



* Pricing and Specs subject to change



LAUGHING CROW ORGANICS
BC, CANADA



TERRENCE JACKSON | BEACH PLUM FARM
CAPE MAY, NJ



AARON SUKO | FULL EARTH FARM
QUINCY, FL



**STEFANI AND JOHN GOETZ | 21 PETALS
LAFAYETTE, IN**



CONGRATULATIONS TO ALL OUR PHOTO CONTEST WINNERS!

**LEARN MORE ABOUT TILMOR'S PHOTO CONTEST
WINNERS AND PRODUCTS ON SOCIAL MEDIA:**



**SAM MCLEMORE | BOUNTIFUL HARVEST FARMS
STARKVILLE, MS**





295 Kurzen Rd. N | 844.255.5864
Dalton, OH 44618 | INFO@TILMOR.COM

**WHEN YOUR LATE NIGHTS
LONG HOURS
CALLOUSED HANDS
& HEAVY LIFTING**

GO UNNOTICED BY MOST.

**WE SEE YOU
& WE SUPPORT YOU.**

