



Release Date: 05/07/2021

Revision Number: 00

Revision Date:

Power Ox 240 Handlebar Kit Assembly

Document Number	Kit Number / Part Number	Model	Serial Number Range
12-70055	AU-9103	240B	All Units

WARNING

Before making repairs or adjustments set the parking brake, turn off engine, and remove ignition key.

Always disconnect the negative battery cable from the battery when working with electrical components. Always work in a manner that does not put safety at risk!

WARNING

Safety glasses must be worn during installation. Ear (hearing) protection must be worn when using air or power tools.

Installation Notes: Right and left hand orientation referred to in these instructions is determined as if facing forward from the operator station.

Installation Time (estimated) 1 hour

Tools Required: 3/8" wrench, 3/8" socket, 1/2" wrench, 1/2" socket, 9/16" wrench, 9/16" socket, Ratchet

Kit Contents		
Part #	Description	Qty.
47-03550	Cable, Throttle Asm 61"	1
47-0475	Cable, Throttle 55.5"	1
64-0602	Bushing, 3/8 x 5/8 x .265	4
85-B0068	Bushing, 3/8 x 1/2 OD x 1/2 LG	6
90-0406	Bolt, 1/4-20 USS x 3/4	2
90-0608	Bolt, 3/8-16 USS x 1	4
95-04	Washer, Flat 1/4 SAE	2
95-06	Washer, Flat 3/8 SAE	4
97-0506	Bolt, Carriage 5/16-18 x 3/4	4
97-0608	Bolt, Carriage 3/8-16 x 1	6
97-0610	Bolt, Carriage 3/8-16 x 1 1/4	4
99-B0055	Washer, Mach 5/8 x 1 x 18Ga	2
99-E0082	Nut, Locking Flange 3/8-16	12
99-E0102	Nut, Locking Flange 5/16-18	4
99-SF04	Nut, SRF 1/4-20 USS	2
AU-1208	Plate, Handle Bar Cross	1
AU-1234	Plate, Handle Connector	1
AU-1240	Plate, Safety Bar	1
AU-6103	Bracket, Handle Frame RH	1
AU-6104	Bracket, Handle Frame LH	1
AU-6105	Bracket, Handle Lever LH	1
AU-6106	Bracket, Handle Lever RH	1
AU-6107	Bracket, Handle Pivot	1
	Cable Tie	1

1. Install the handle levers (A) onto the handle pivot shaft (B).

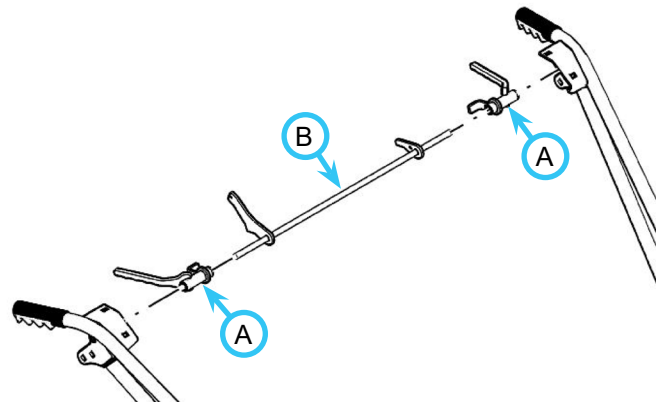

2. Ensure that the handle lever catch brackets (C) are under the pivot shaft brackets (D).

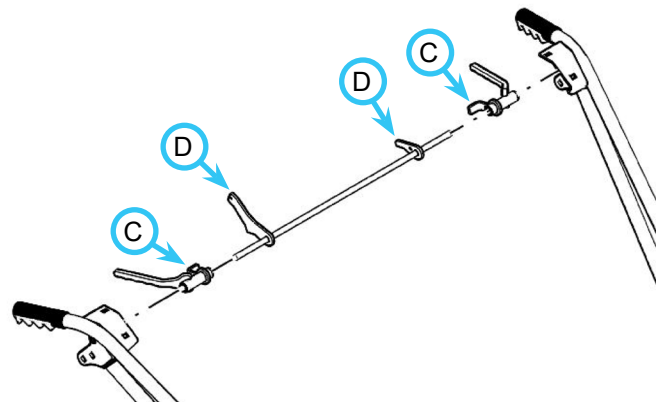

3. Install the handlebar frames onto the pivot shaft.

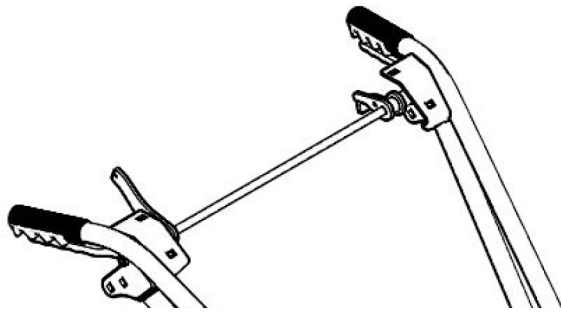

4. Install the handlebar cross plate (E). Secure the plate in place using four 5/16 x 3/4" carriage bolts and locknuts tightened hand tight.

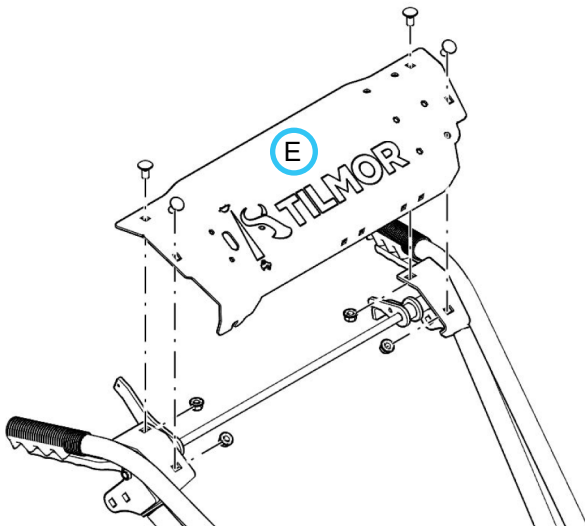

5. Install the handle connector plate (F). Secure the plate in place using four 3/8 x 1" carriage bolts and locknuts tightened hand tight.

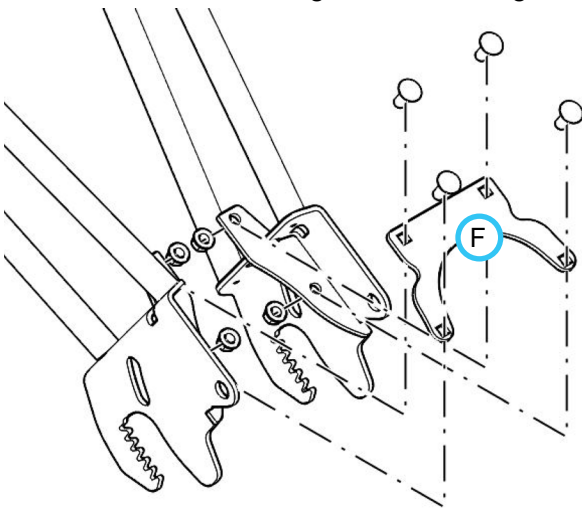

6. Tighten the handle bar cross plate and the connector plate alternating between all of the bolts. Frequently check the operation of the drive control handles ensure that the handles move freely with no binding.

7. Position the handlebar assembly in the frame.

8. Install four 3/8" bolts, washers, bushings, and locking flange nuts.

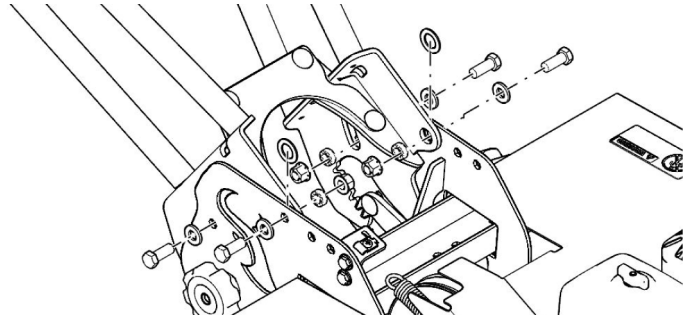

9. Route the drive control cable (G) through the handle bar frame at points (H).

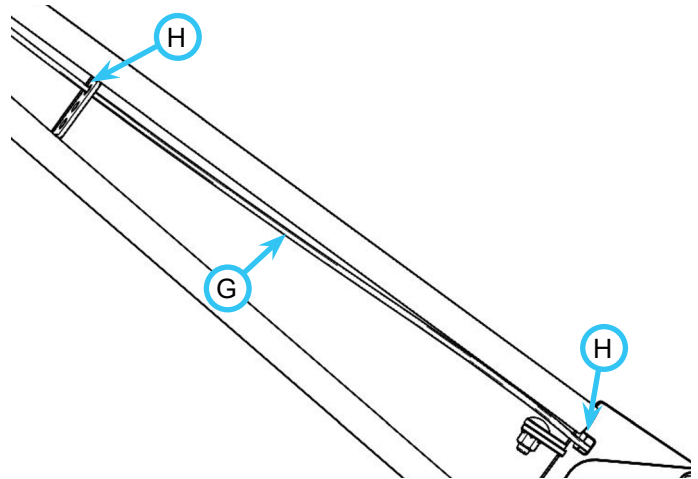

10. Connect the cable to the drive control mechanism (I) and secure the cable to the handlebar cross plate (J).

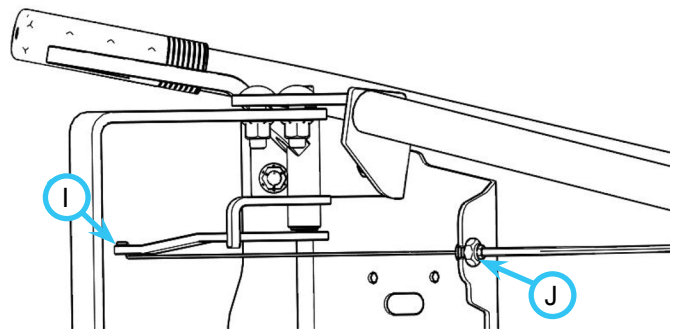

11. Connect the cable to the spring (K) and secure in place using the cable clamp (L).

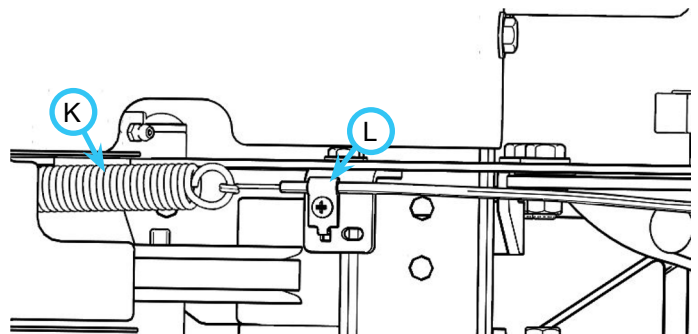

12. Remove the ball handle (M) from the throttle cable.

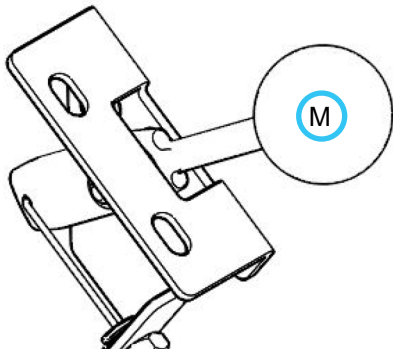

13. Route the throttle cable (N) through the handlebar frame at points (O).

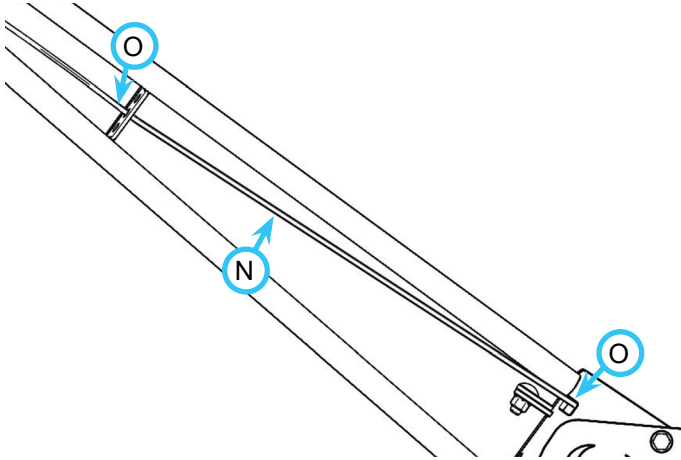

14. Place the throttle control handle through the handlebar cross plate and install the ball handle.
15. Secure the throttle control assembly to the handlebar cross plate using 1/4 x 3/4" bolts (P), washers, and locking flange nuts.

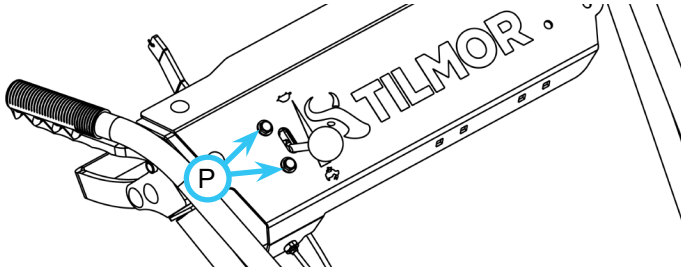

16. Install the ball handle onto the throttle lever.
17. Remove the engine air filter assembly (Q).



18. Connect the cable to the throttle control lever (R).

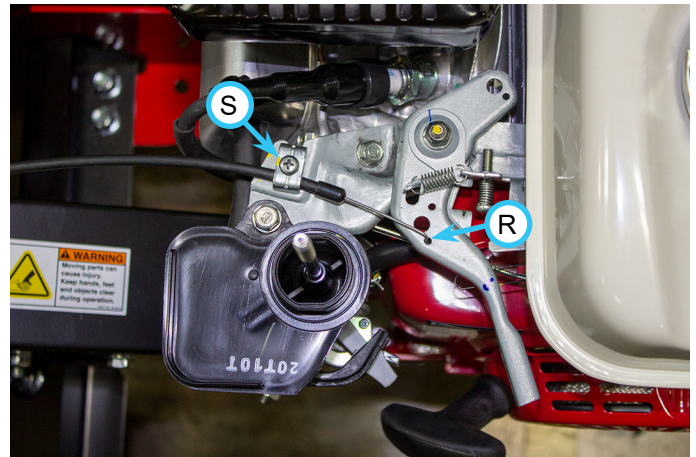

19. Secure the throttle cable in place using the clamp (S).
20. Secure the throttle cable to the bracket using a cable tie (T).

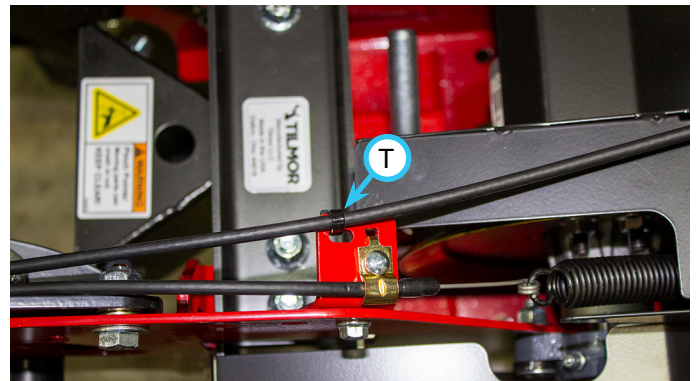

21. Check the throttle lever functionality ensure that the throttle lever moves smoothly.
22. Install the air cleaner assembly.
23. Check the drive control functionality. Ensure that the drive belt disengages when the drive control handles are released.
24. Install the safety bar (U) using four 3/8 x 1-1/4" carriage bolts and nuts.

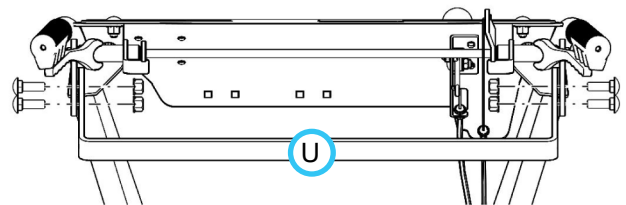

25. If needed adjust the drive control cable in accordance with the Power Ox 240B Operator's Manual.