

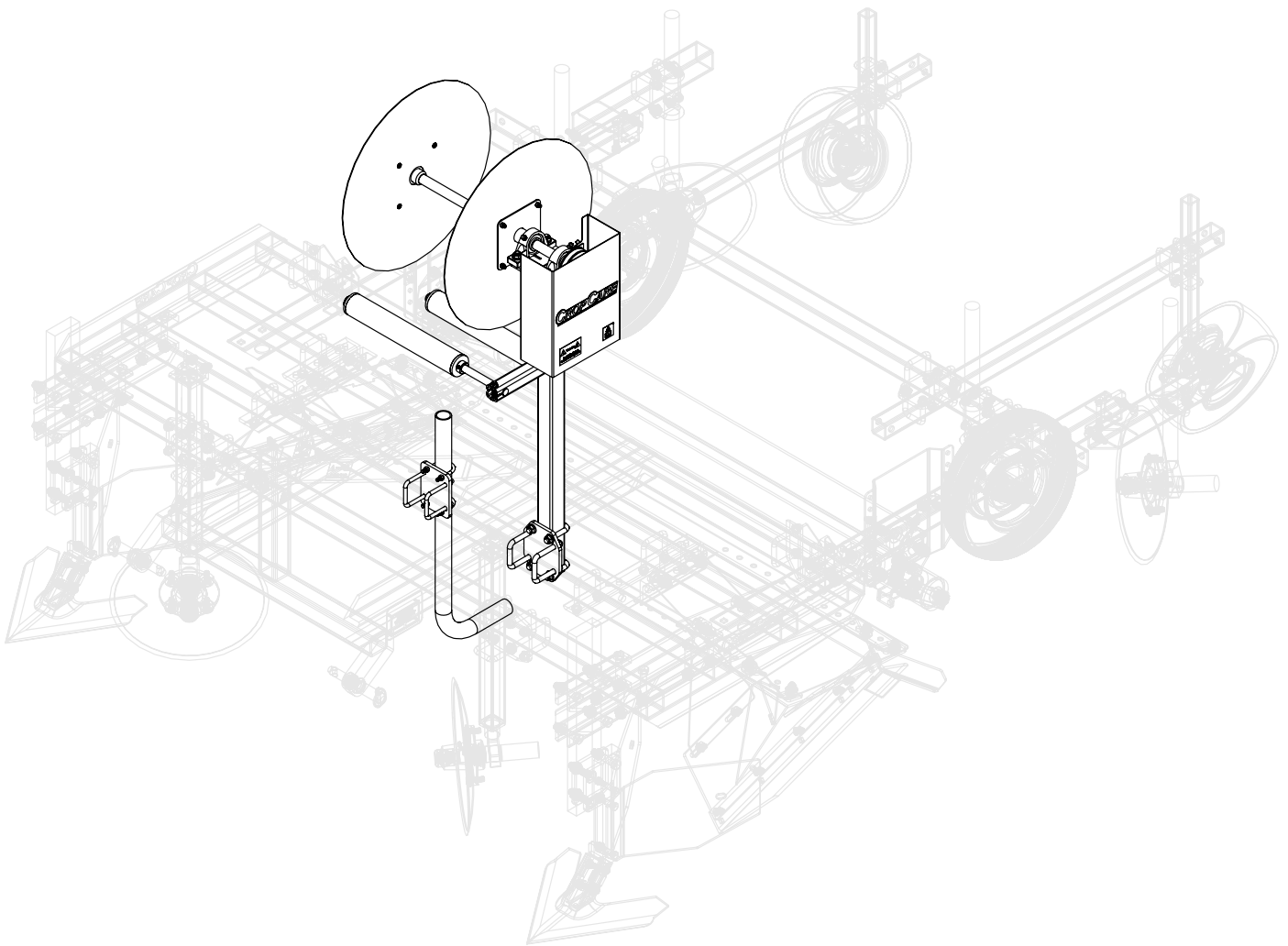

Assembly Manual

Model: DT4610AM
Drip Tape Applicator



Manufactured by PBZ LLC
A Paul B Zimmerman Inc. Company
www.CropCareEquipment.com

Form DT4610AM
Rev. A Date: 5/21

DT4610 Assembly Instructions

Pallet Contents

The Drip Tape Applicator comes partially assembled and requires some additional assembly to complete it. Follow the step-by-step instructions to ensure proper assembly. Before assembling, ensure that the pallet contains all of the necessary components and parts.

NOTE: Shown as double reel kit, the single reel kit contains half of the components shown and listed (Item 2 is only included in a double reel kit). All items shown, except items 3 and 4, are clamped onto the Bed Shaper / Plastic Layer inside the crate.

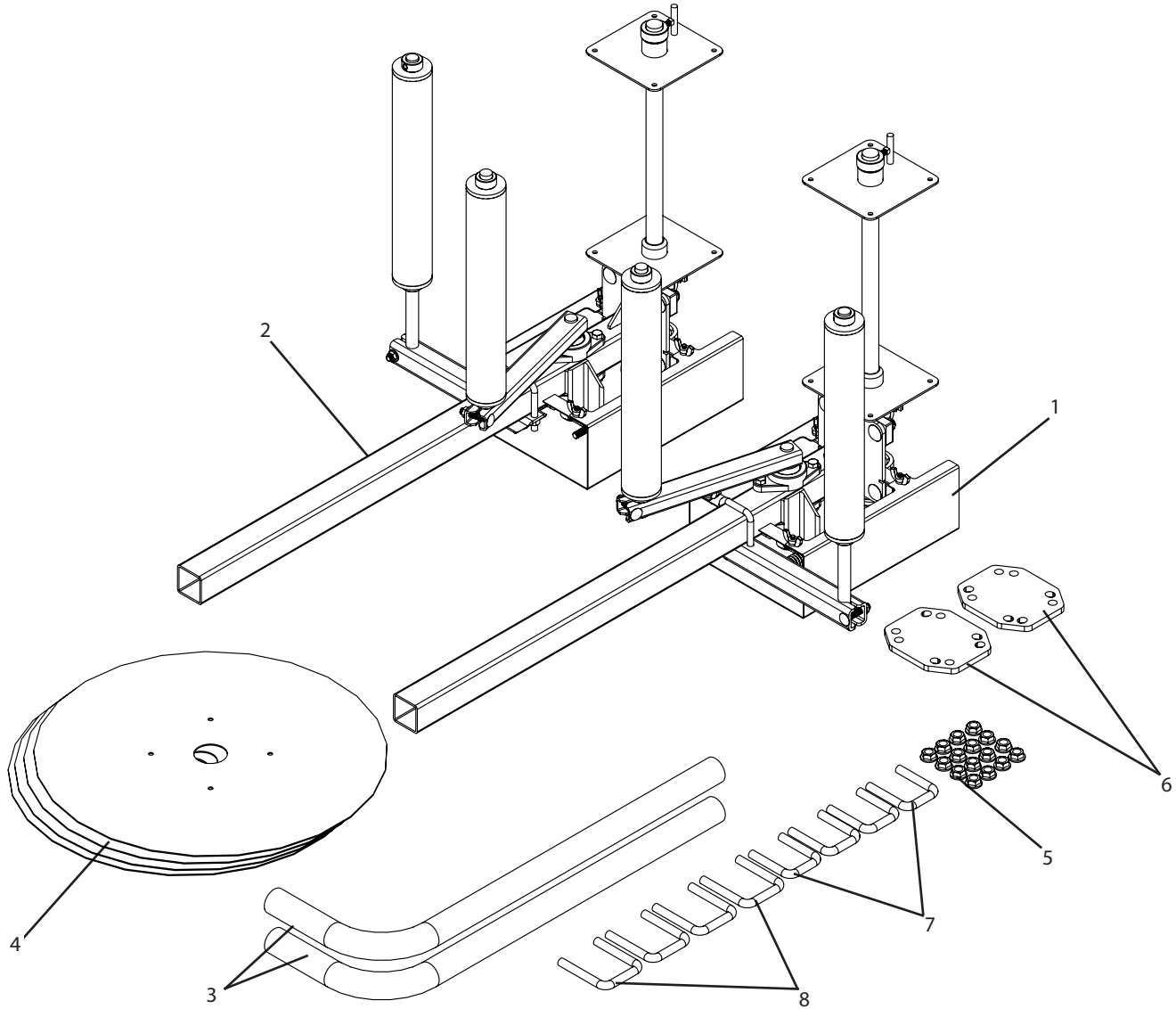

Ref#	Qty.	Part #	Description
1	1	DT4610A	Drip Tape Applicator, Single Reel Subassembly
2	1	DT4610B	Drip Tape Applicator, Single Reel Subassembly, Opposite Hand
3	2	DTA110	Drip Tape Applicator, Injector, 5in depth
4	4	DTA112	Drip Tape Applicator, Roll Cap, 21in dia
5	16	FN12	Nut, Flange 1/2-13
6	2	RBL150	Plastic Layer, Toolbar Clamp Plate
7	4	UBSQ08X0208X0308	U-bolt, Square, 1/2-13 x 2 1/2" ID width x 3 1/2" ID length, zinc
8	4	UBSQ08X02X03	U-bolt, Square, 1/2-13 x 2" ID width x 3" ID length, zinc

DT4610 Assembly Instructions

Hardware Box Contents

These items are inside the hardware box for the Bed Shaper / Plastic Layer unit.

NOTE: Shown as double reel kit, the single reel kit contains half of the components shown and listed.

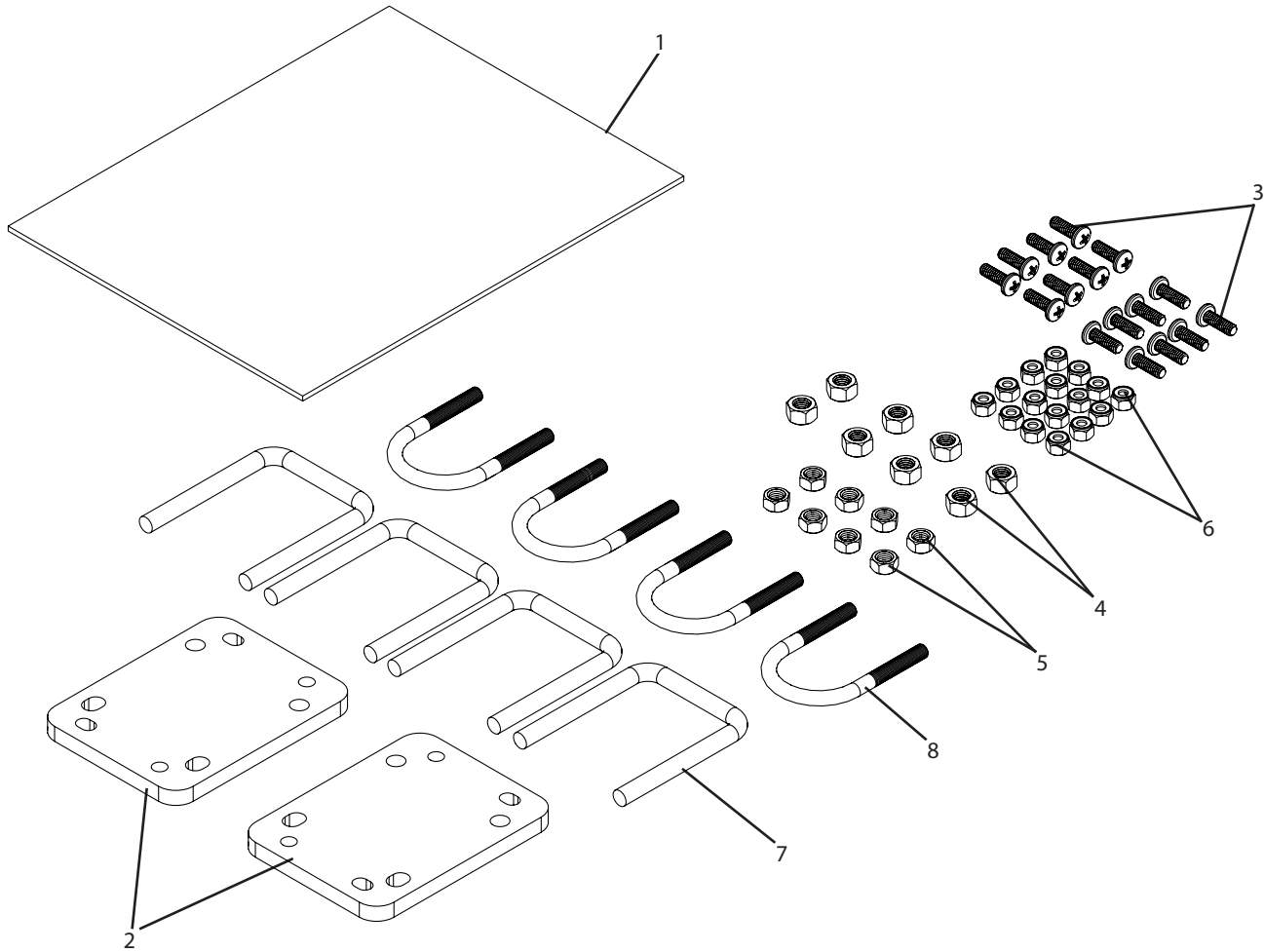

Ref#	Qty.	Part #	Description
1	1	DT4610OM	Manual, Owners, Drip Tape Applicator
2	2	DTA101	Drip Tape Applicator, Shank Clamp
3	16	MR14X34	Machine Screw Combo 1/4-20 x 3/4
4	8	NC38	Nut, Hex 3/8-16
5	8	NC516	Nut, Hex 5/16-18
6	16	NNC14	Nut, Lock Nylon 1/4-20
7	4	UBSQ06X0208X0308	U-bolt, Square, 3/8-16 x 2 1/2" ID width x 3 1/2" ID length, Zinc
8	4	N222141	Bolt, U-Bolt Round 5/16-18 x 1-3/8" x 2-1/2"

DT4610 Assembly Instructions

The Drip Tape Applicator can be set up for use based on the following:

- Whether there are one or two drip tape lines in the produce bed.
- If two drip tape lines are to be installed the setup will need to allow for how far apart the two lines will be spaced.

Single Drip Tape Setup (with Drip Tape Roll Unrolling Forward)

- Install the drip tape reel posts onto the toolbar frame with the reel mounted so that the drip tape will unroll forward.
- NOTE: The position of the brake arm on the reel should be closest to the rear of the unit as shown.
- The Drip Tape Guide and the Drip Tape Reel are mounted on the same toolbar (first or second from the front) in this type of setup.

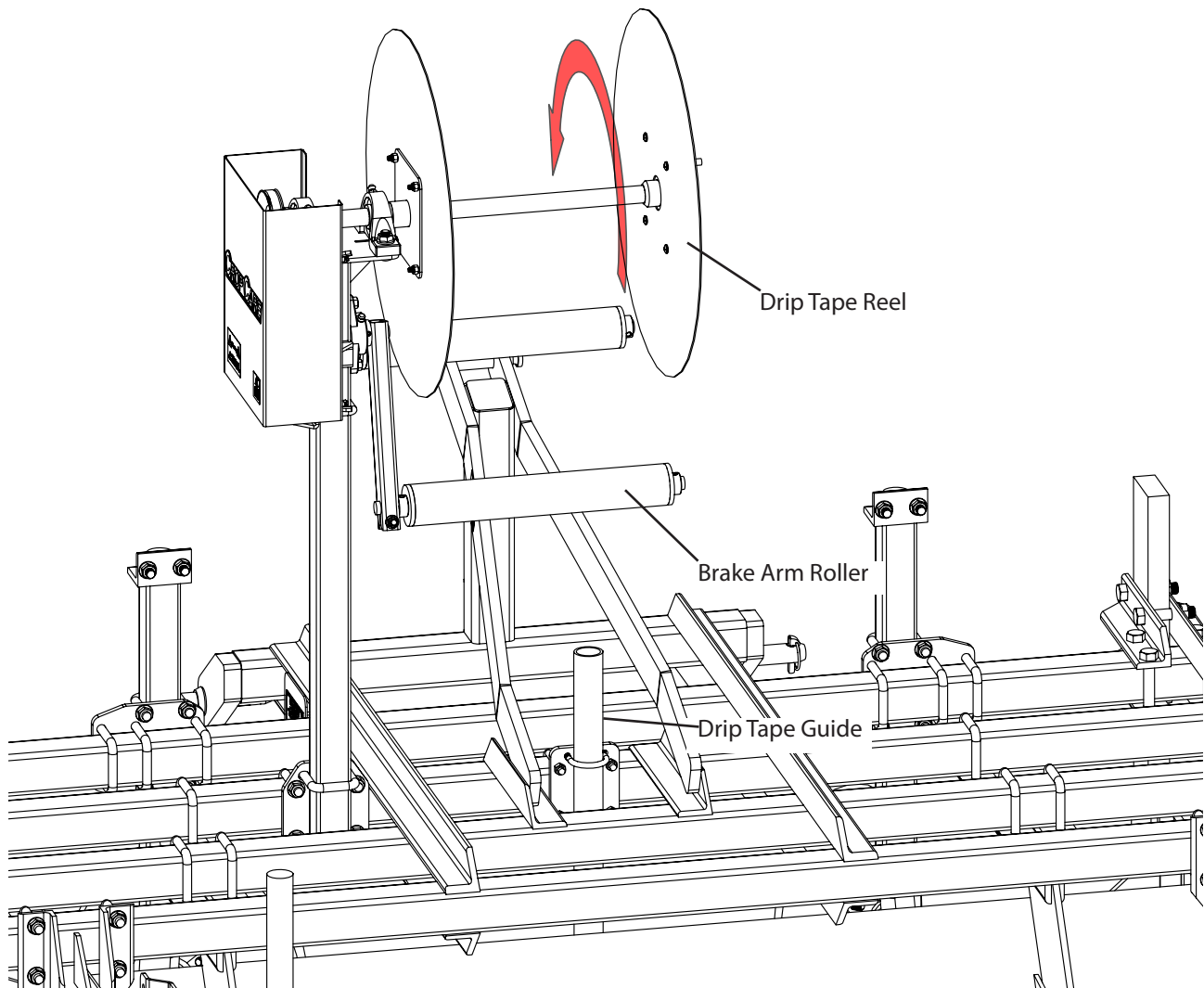

DT4610 Assembly Instructions

Single Drip Tape Setup (with Drip Tape Roll Unrolling to Side)

- Install the drip tape reel posts onto the toolbar frame with the reel mounted so that the drip tape will unroll towards one side.
- The Drip Tape Guide and the Drip Tape Reel are mounted on different toolbars (the first, second, or third from the front) in this type of setup.

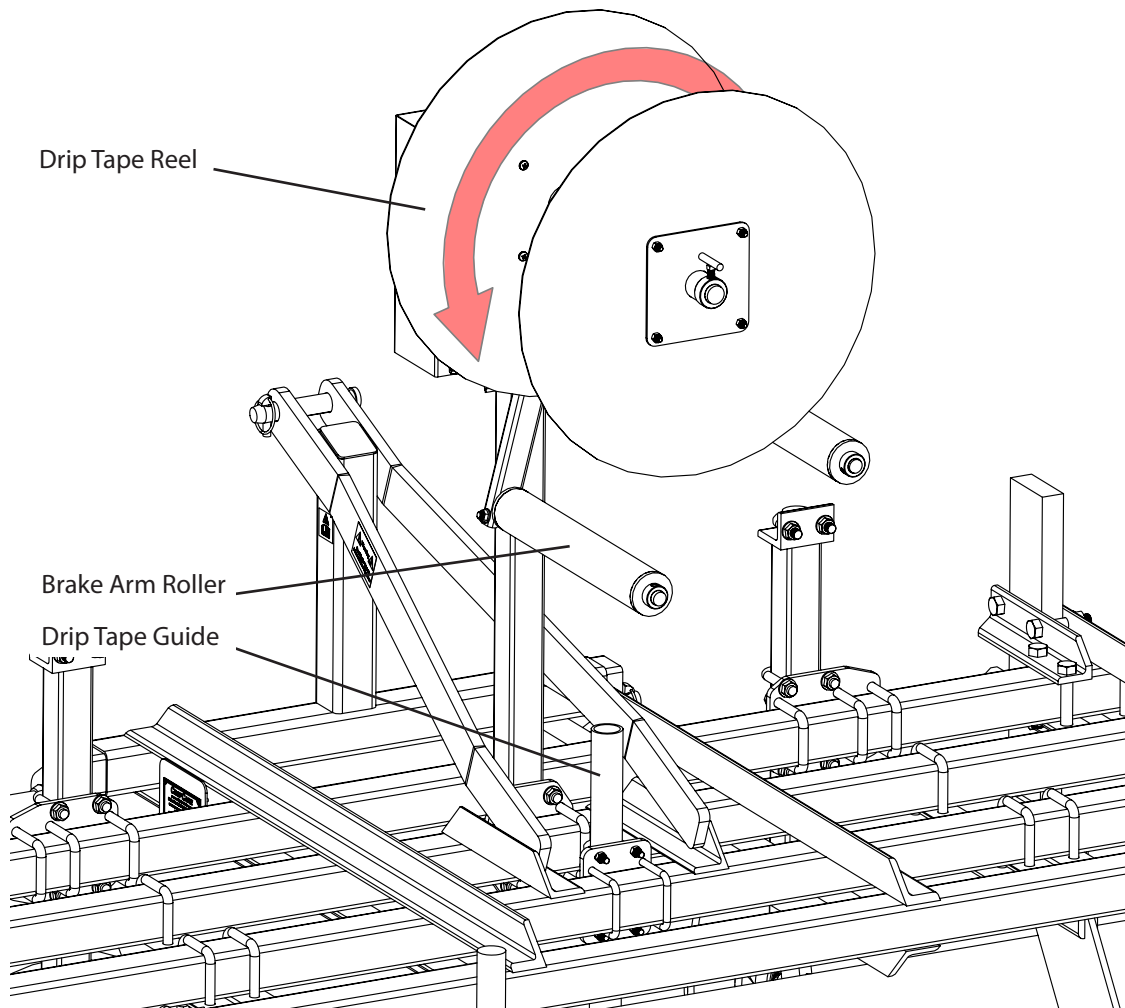

DT4610 Assembly Instructions

Dual Drip Tape Setup (with Drip Tape Roll Unrolling Forward)

- Install the drip tape reel posts onto the toolbar frame with the reel mounted so that the drip tape will unroll towards one side.
- NOTE: The position of the brake arm on each reel should be closest to the rear of the unit as shown.
- The Drip Tape Guides and the Drip Tape Reels are mounted on the same toolbars (the second or third from the front) in this type of setup.

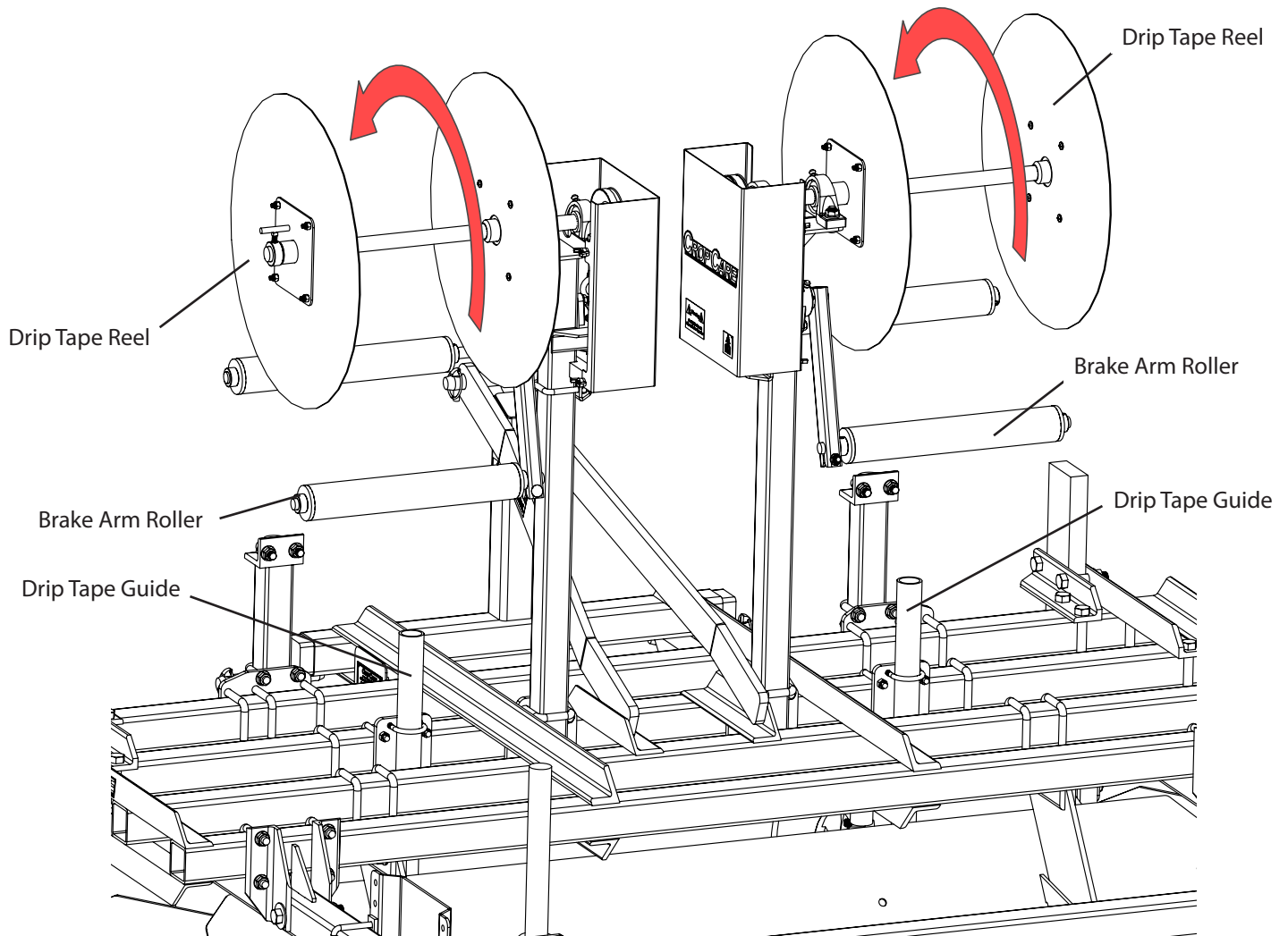

DT4610 Assembly Instructions

Dual Drip Tape Setup (with Drip Tape Roll Unrolling to Side)

- Install the drip tape reel posts onto the toolbar frame with the reel mounted so that the drip tape will unroll towards one side. This setup allows for narrow drip tape spacing in the produce bed.
- NOTE: The position of the brake arm on each reel should be in between the two reels as shown.
- The Drip Tape Guides and the Drip Tape Reels are mounted on different toolbars (the second and third from the front) in this type of setup.

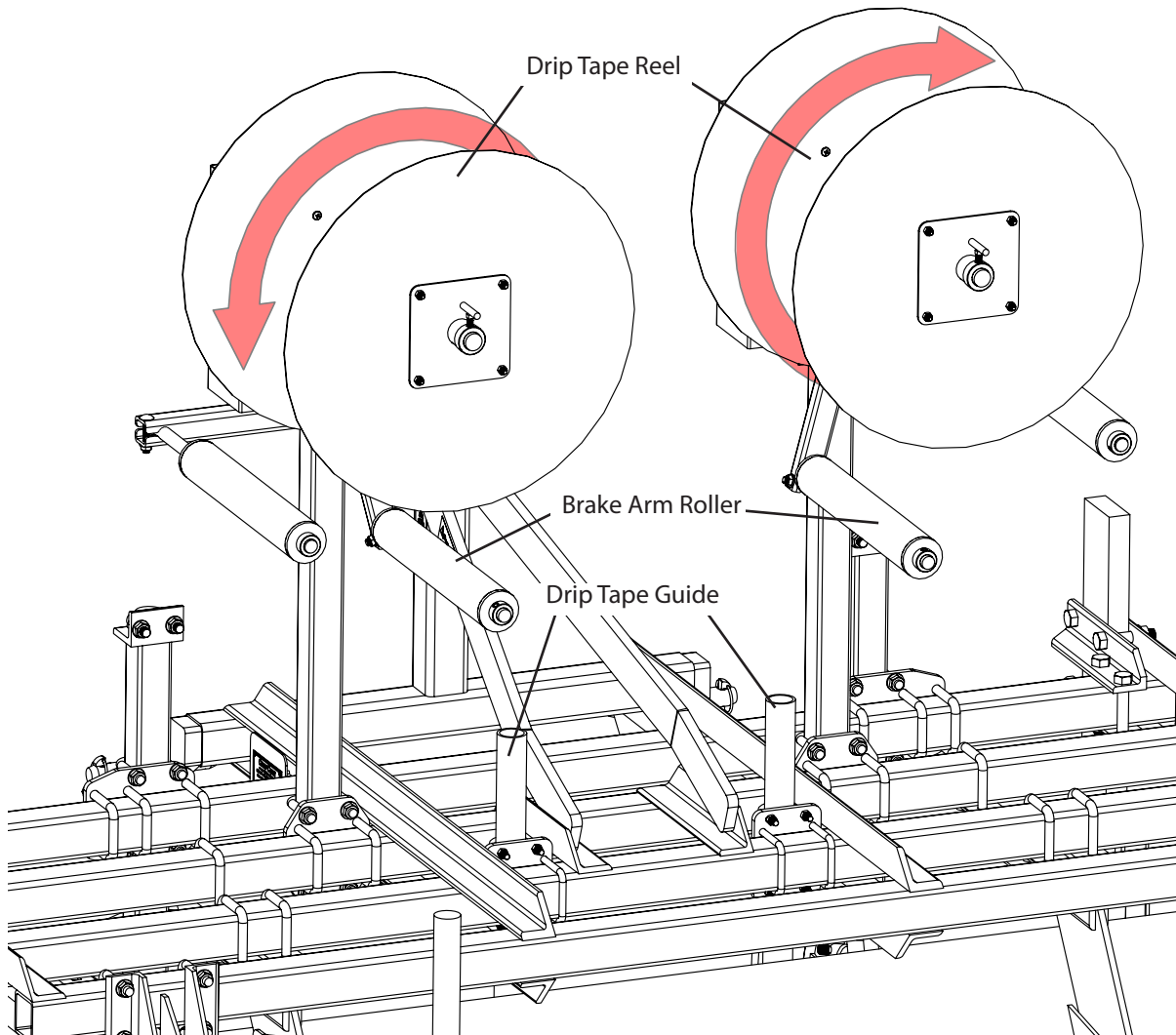

DT4610 Assembly Instructions

Assembly Step 1

- After uncrating the unit, remove the drip tape reel post assembly from the toolbar.

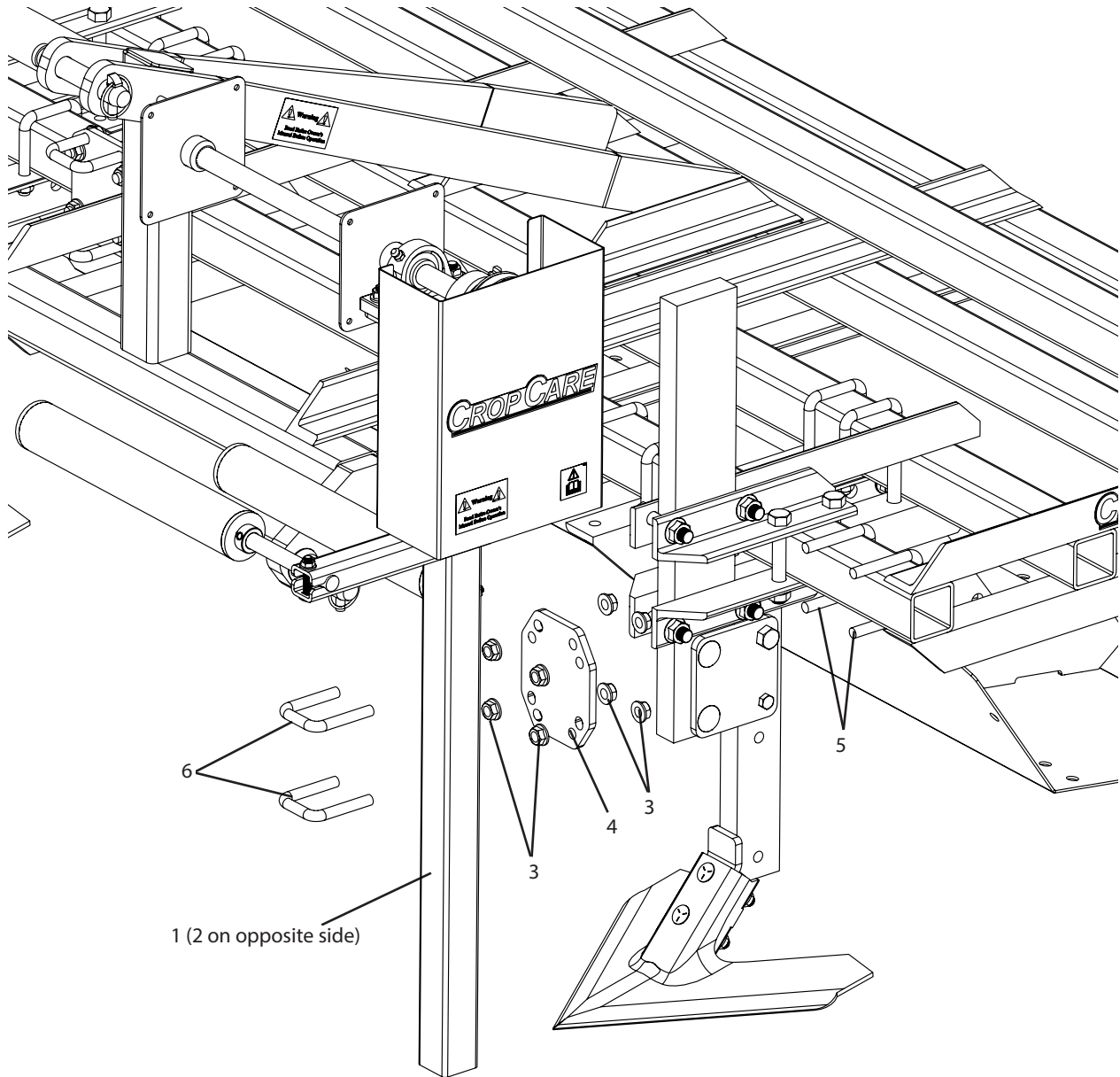

Ref#	Qty.	Part #	Description
1	1	DT4610A	Drip Tape Applicator, Single Reel Subassembly
2	1	DT4610B	Drip Tape Applicator, Single Reel Subassembly, Opposite Hand
3	16	FN12	Nut, Flange 1/2-13
4	2	RBL150	Plastic Layer, Toolbar Clamp Plate
5	4	UBSQ08X0208X0308	U-bolt, Square, 1/2-13 x 2 1/2" ID width x 3 1/2" ID length, zinc
6	4	UBSQ08X02X03	U-bolt, Square, 1/2-13 x 2" ID width x 3" ID length, zinc

DT4610 Assembly Instructions

Assembly Step 2

- Install the Drip Tape Guide onto toolbar. Set depth (refer to owner's manual for details).

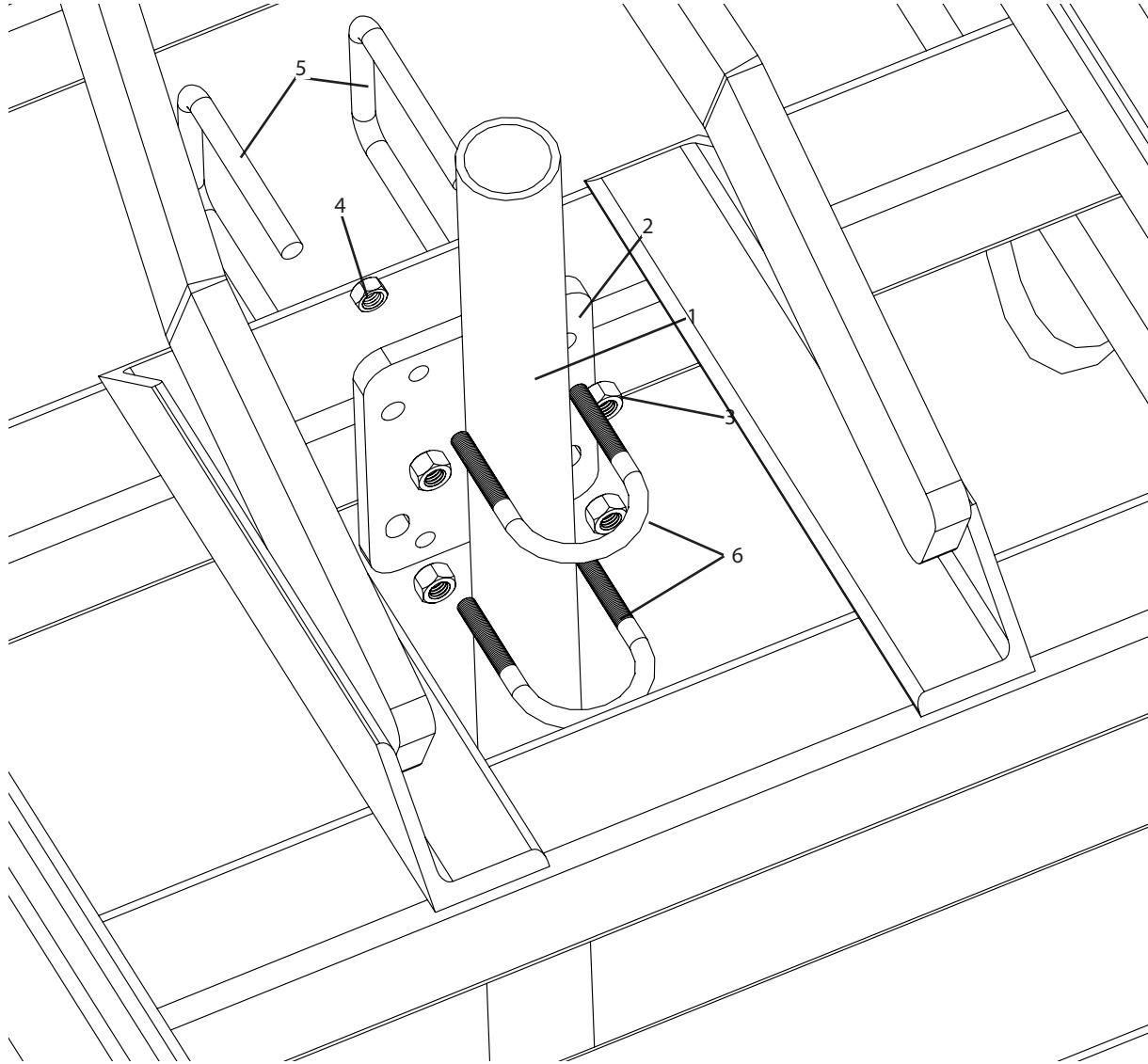

Ref#	Qty.	Part #	Description
1	1	DTA110	Drip Tape Applicator, Injector, 5in depth
2	1	DTA101	Drip Tape Applicator, Shank Clamp
3	4	NC38	Nut, Hex 3/8-16
4	4	NC516	Nut, Hex 5/16-18
5	2	UBSQ06X0208X0308	U-bolt, Square, 3/8-16 x 2 1/2" ID width x 3 1/2" ID length, Zinc
6	2	N222141	Bolt, U-Bolt Round 5/16-18 x 1-3/8" x 2-1/2"

DT4610 Assembly Instructions

Assembly Step 3

- Install the Drip Tape Reel onto the toolbar.

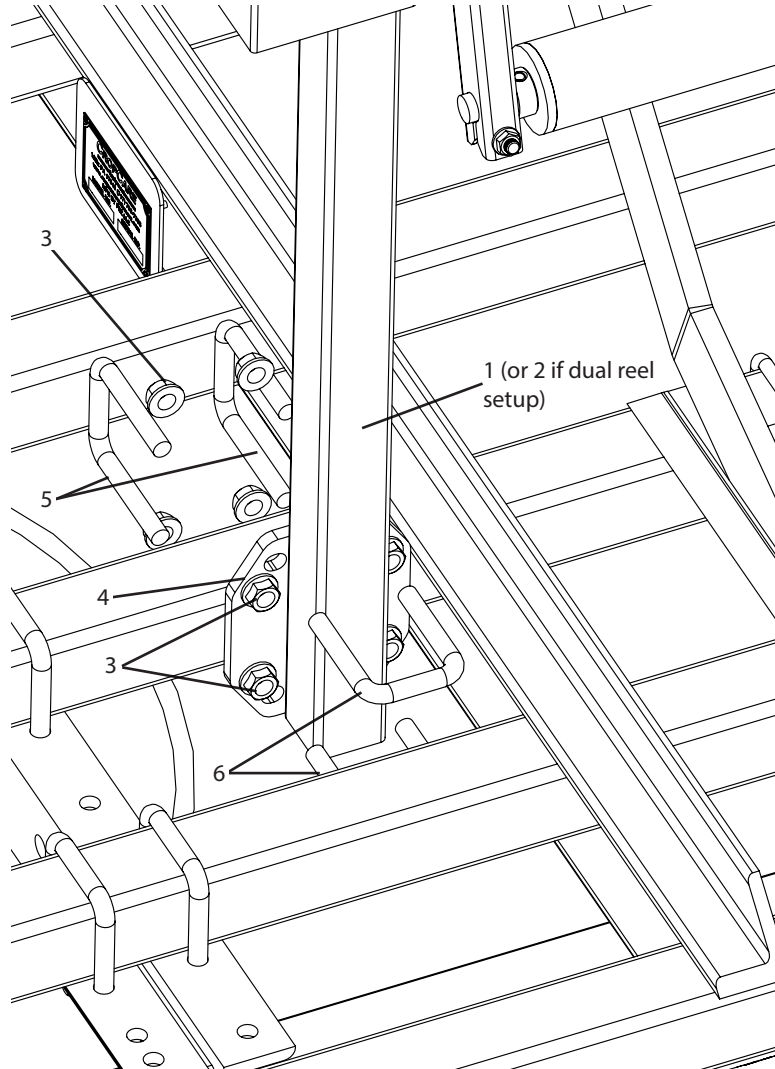

Ref#	Qty.	Part #	Description
1	1	DT4610A	Drip Tape Applicator, Single Reel Subassembly
2	1	DT4610B	Drip Tape Applicator, Single Reel Subassembly, Opposite Hand
3	8	FN12	Nut, Flange 1/2-13
4	1	RBL150	Plastic Layer, Toolbar Clamp Plate
5	2	UBSQ08X0208X0308	U-bolt, Square, 1/2-13 x 2 1/2" ID width x 3 1/2" ID length, zinc
6	2	UBSQ08X02X03	U-bolt, Square, 1/2-13 x 2" ID width x 3" ID length, zinc

DT4610 Assembly Instructions

Assembly Step 4

- Install the Drip Tape Roll Caps onto reels.

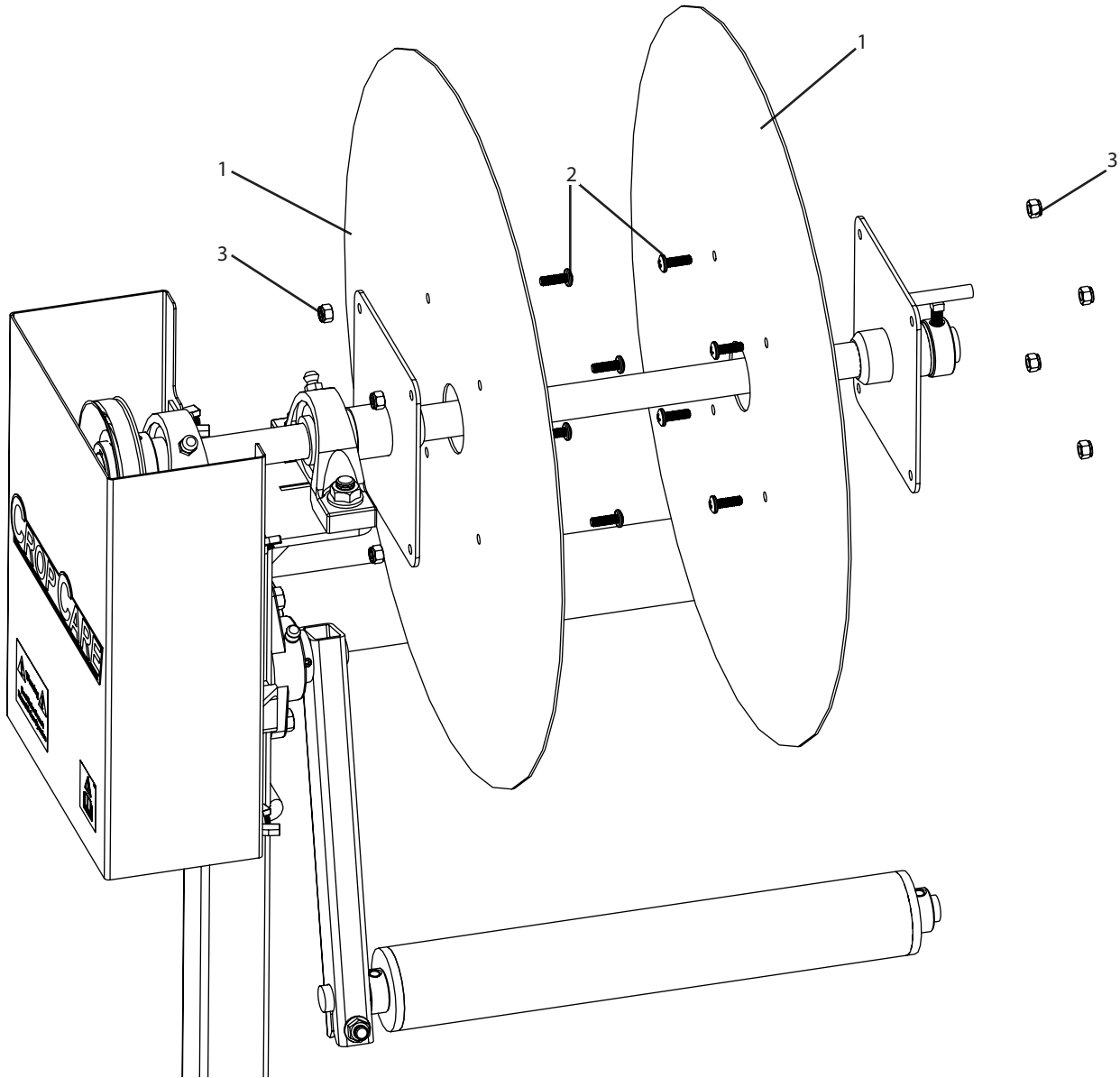

Ref#	Qty.	Part #	Description
1	2	DTA112	Drip Tape Applicator, Roll Cap, 21in dia
2	8	MR14X34	Machine Screw Combo 1/4-20 x 3/4
3	8	NNC14	Nut, Lock Nylon 1/4-20