



Tensioner Assembly Replacement

Document Number	Model	Serial Number Range	Part Number
12.80003	AB-100 Plastic Winder	All Units	

⚠ WARNING

Before making repairs or adjustments set the parking brake, turn off engine, and remove ignition key.
Always disconnect the negative battery cable from the battery when working with electrical components. Always work in a manner that does not put safety at risk!

⚠ WARNING

Safety glasses must be worn during installation. Ear (hearing) protection must be worn when using air or power tools.

Installation Notes: Right and left hand orientation referred to in these instructions is determined as if facing forward from the operator station.

Installation Time (estimated) 1.5 hours

Tools Required: 7/16" wrench, 7/16" socket, 9/16" wrench, 9/16" socket, 3/4" wrench, 3/4" socket, Torque wrench, Ratchet

1. Remove the tension from the belt by adjusting the tensioner (A) to the lowest position (B).

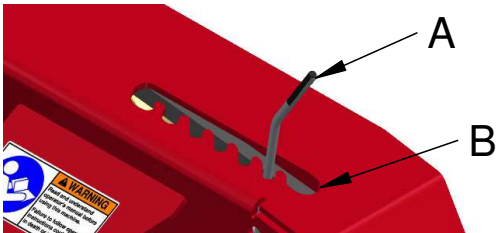

2. Remove the seven 1/4" bolts (D) and the seven 1/4" flat washers (E) around the outside perimeter of the pulley cover.

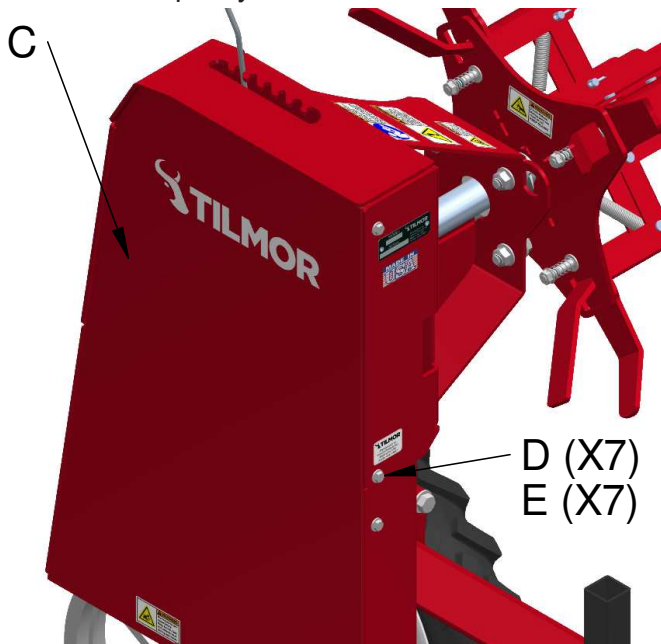

3. Remove the pulley cover (C).
4. Remove the belt from the pulleys.

5. To remove the idler pulley (E), remove the 3/8" bolt (F) secured in place by the 3/8" locking flange nut.

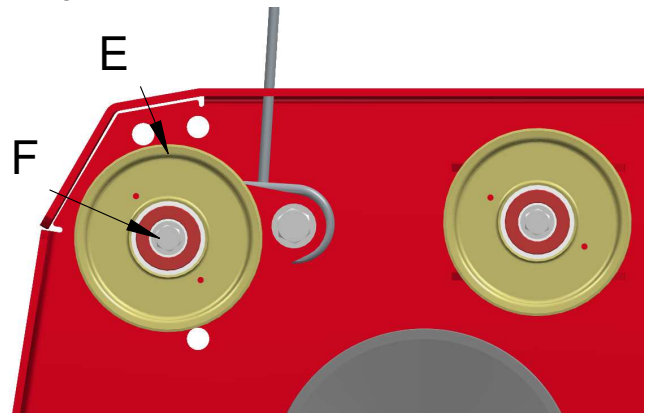

6. Remove the tensioner assembly by removing the 1/2" locking nut (G) that secures the tensioner to the top cover.



- Position the new tensioner in the top cover inserting the mounting bolt through the upper mounting hole (H).

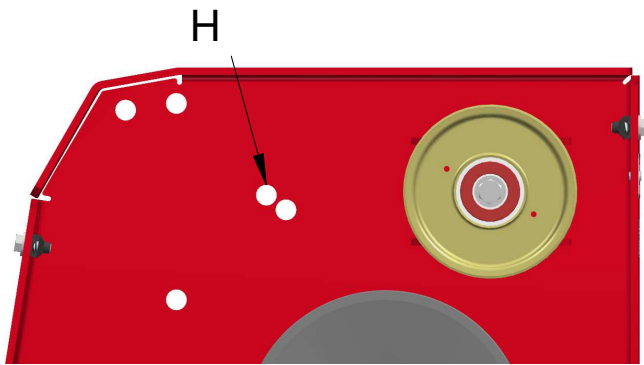

- Ensure that the torsion spring adjustment handle (I) is placed through the top cover (J).

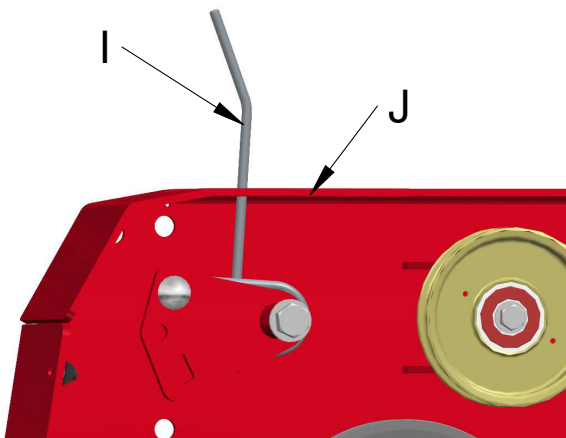

- Secure the tensioner in place with the 1/2" locking flange nut. Torque the flange nut to 85 ft-lbs (115 Nm).
- Place a 3/8" washer on the 3/8" bolt, followed by the new idler pulley and another 3/8" washer as shown below.

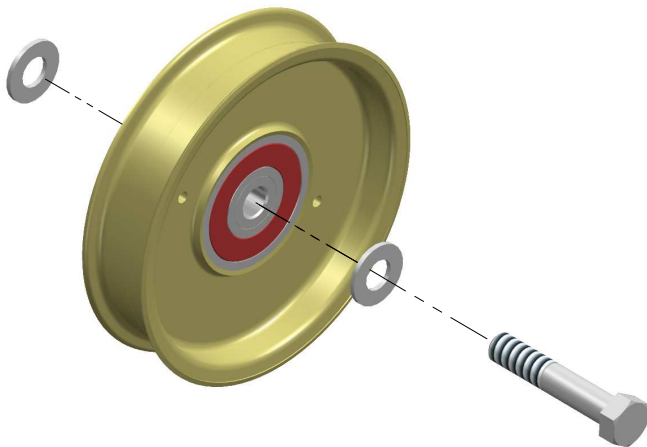

- Install the pulley onto the tensioner pulley mount in the center mounting hole (K).

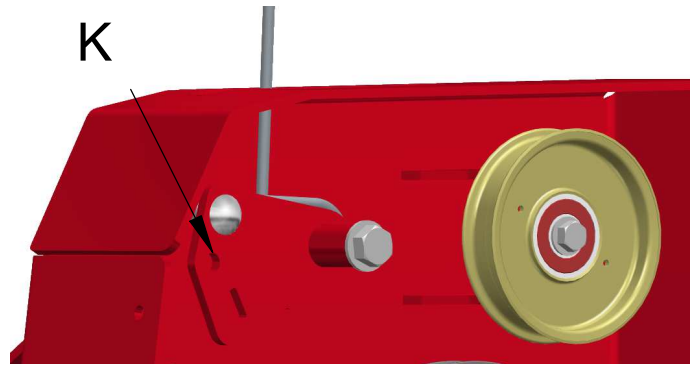

- Secure the new tensioner pulley in place using a 3/8" locking flange nut.
- Torque the 3/8" bolt to 35 ft-lbs (47 Nm).
- Ensure that the tensioner pulley is in line with the idler pulley and the reel drive pulley.
- Install the belt, by routing the belt around the pulleys as shown below.

	Attention
NOTE: The V portion of the belt must be on the plastic winder reel drive pulley (L).	

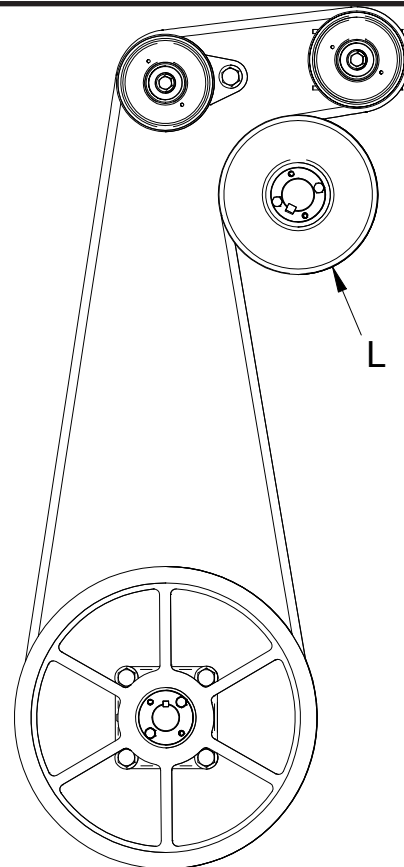

- Set the belt tension as required by adjusting the tension adjustment lever.
- Reinstall the pulley cover. Torque the 1/4" bolts to 100 in-lbs (11 Nm).