

Tensioner Spring Replacement

| Document Number | Model | Serial Number Range | Part Number |
|-----------------|-----------------------|---------------------|-------------|
| 12.80003 | AB-100 Plastic Winder | All Units | AW-3069 |

⚠ WARNING

Before making repairs or adjustments set the parking brake, turn off engine, and remove ignition key.
Always disconnect the negative battery cable from the battery when working with electrical components. Always work in a manner that does not put safety at risk!

⚠ WARNING

Safety glasses must be worn during installation. Ear (hearing) protection must be worn when using air or power tools.

Installation Notes: Right and left hand orientation referred to in these instructions is determined as if facing forward from the operator station.

Installation Time (estimated)

1 hour

Tools Required: 7/16" wrench, 7/16" socket, 9/16" wrench, 9/16" socket, 3/4" wrench, 3/4" socket, Torque wrench, Ratchet

1. Remove the tension from the belt by adjusting the tensioner (A) to the lowest position (B).

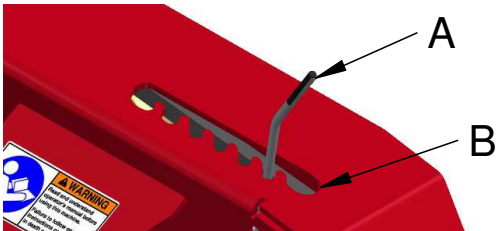

2. Remove the seven 1/4" bolts (D) and the seven 1/4" flat washers around the outside perimeter of the pulley cover.

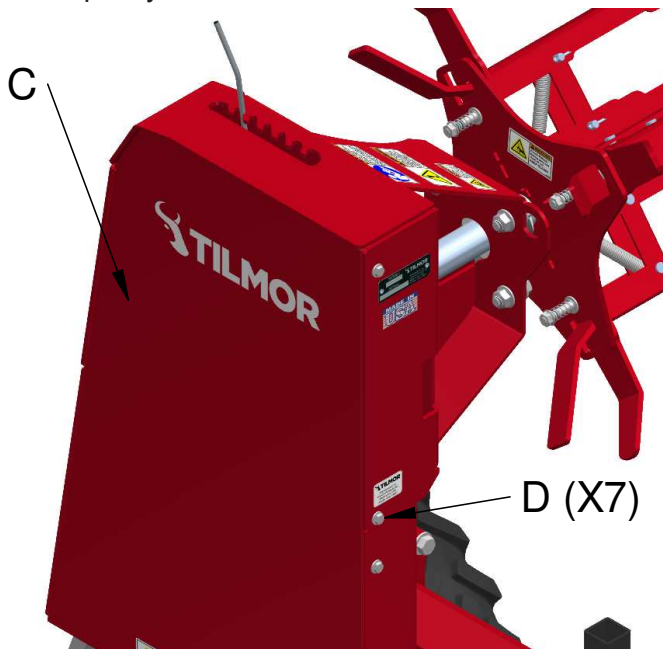

3. Remove the pulley cover (C).
4. Remove the belt from the pulleys.

5. To remove the idler pulley (F), remove the 3/8" bolt (E) secured in place by the 3/8" locking flange nut.

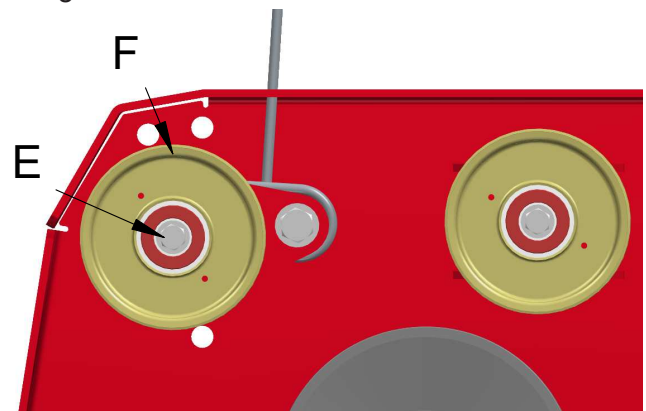

6. Remove the tensioner assembly by removing the 1/2" locking nut (G) that secures the tensioner to the top cover.



7. Remove the 3/8" locking flange nut (I) and 3/8" carriage bolt (J) from the tensioner assembly.

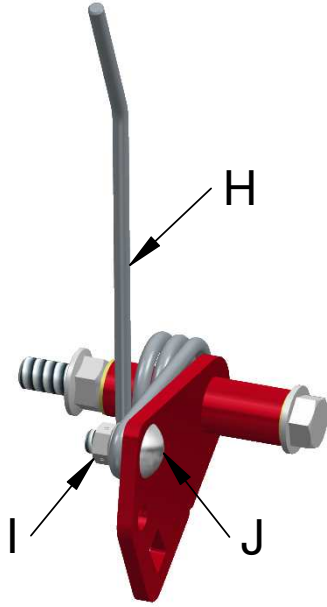

8. Remove the torsion spring (H) from the tensioner assembly.
9. Position the 3/8" carriage bolt (K) through the tensioner assembly mounting bracket. Ensure that the carriage bolt is centered in the mounting hole.

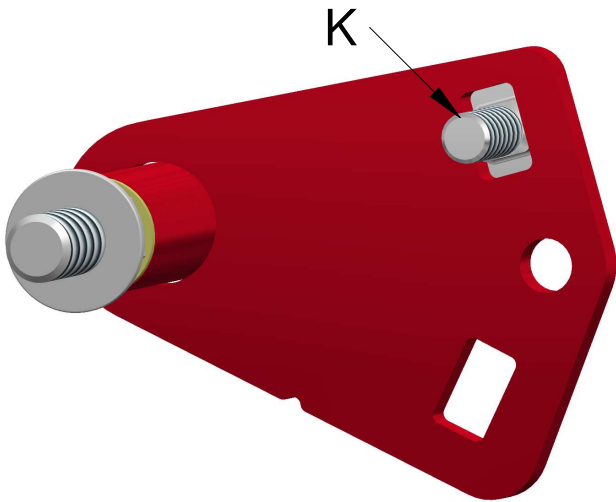

10. Position the new torsion spring on to the mounting bracket.

11. Secure the torsion spring in place using a 3/8" locking flange nut (L). Torque the flange nut to 31 ft-lbs (42 Nm).



12. Position the new tensioner in the top cover. Insert the tensioner mounting bolt through the upper mounting hole (M).

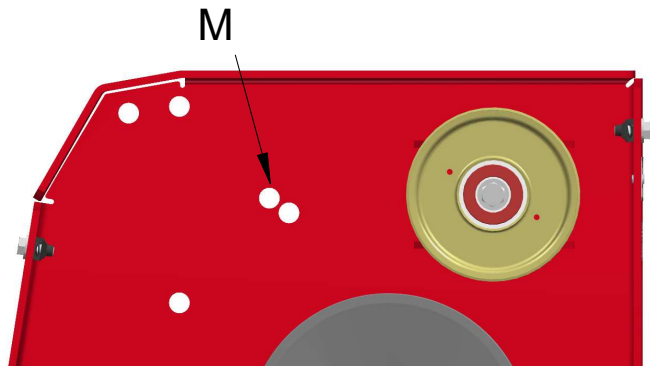

13. Ensure that the torsion spring adjustment handle (N) is placed through the top cover (O).

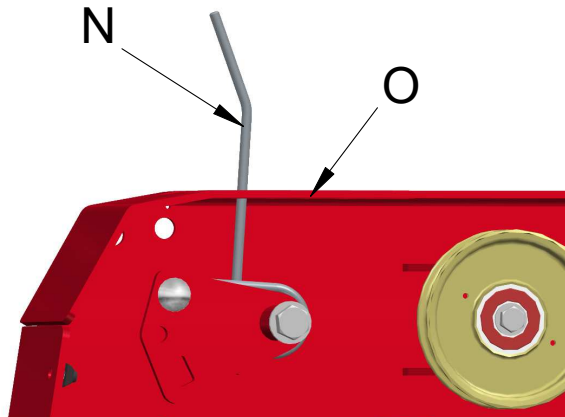

14. Secure the tensioner in place with the 1/2" locking flange nut. Torque the flange nut to 85 ft-lbs (115 Nm).
15. Place a 3/8" washer on the 3/8" bolt, followed by the new idler pulley and another 3/8" washer as shown below.

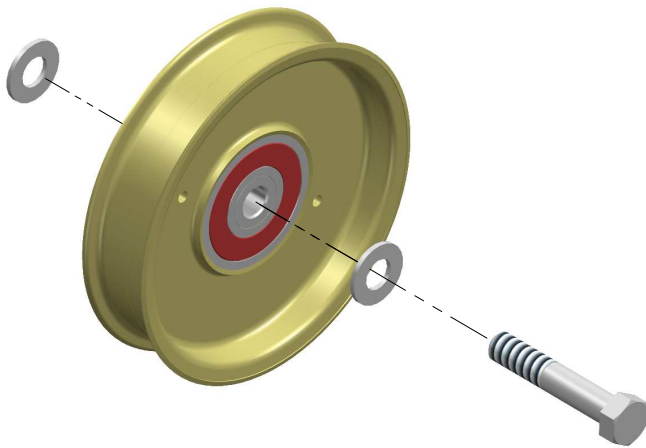

16. Install the pulley onto the tensioner pulley mount in the center mounting hole (P).

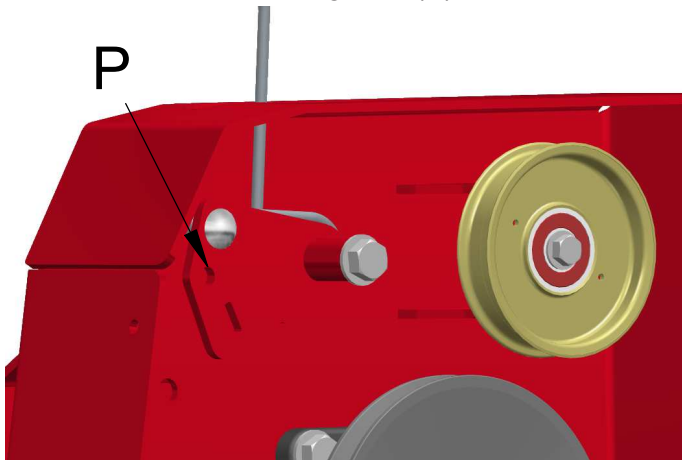

17. Secure the new tensioner pulley in place using a 3/8" locking flange nut.
18. Torque the 3/8" bolt to 35 ft-lbs (47 Nm).
19. Ensure that the tensioner pulley is in line with the idler pulley and the reel drive pulley.

20. Install the belt, by routing the belt around the pulleys as shown below.

| | |
|--|------------------|
| | Attention |
| NOTE: The V portion of the belt must be on the plastic winder reel drive pulley (Q). | |

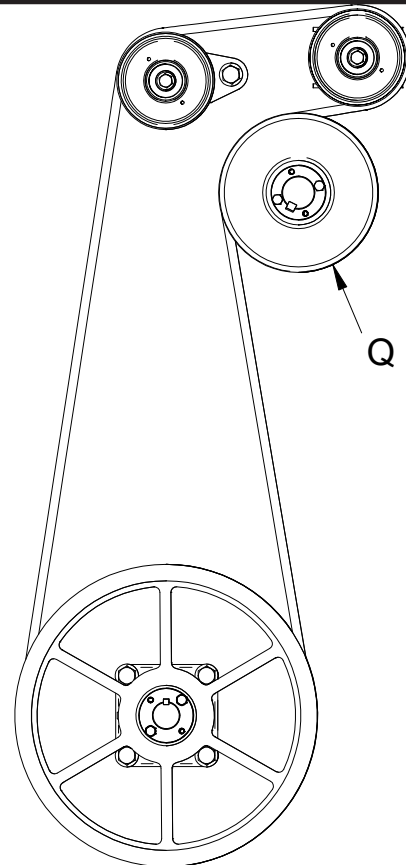

21. Set the belt tension as required by adjusting the tension adjustment lever.
22. Reinstall the pulley cover. Torque the 1/4" bolts to 100 in-lbs (11 Nm).