

## Idler Pulley Replacement

Document Number	Model	Serial Number Range	Part Number
12.80005	AB-100 Plastic Winder	All Units	83.0037

### ⚠ WARNING

Before making repairs or adjustments set the parking brake, turn off engine, and remove ignition key.  
Always disconnect the negative battery cable from the battery when working with electrical components. Always work in a manner that does not put safety at risk!

### ⚠ WARNING

Safety glasses must be worn during installation. Ear (hearing) protection must be worn when using air or power tools.

**Installation Notes:** Right and left hand orientation referred to in these instructions is determined as if facing forward from the operator station.

**Installation Time (estimated)** 1 hour

**Tools Required:** 7/16" wrench, 7/16" socket, 9/16" wrench, 9/16" socket, Torque wrench, Ratchet

1. Remove the tension from the belt by adjusting the tensioner (A) to the lowest position (B).

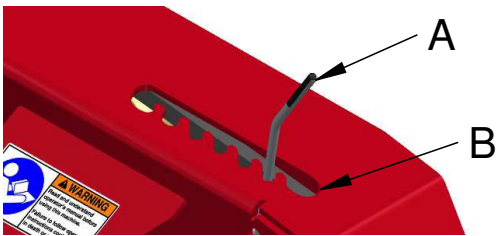

2. Remove the seven 1/4" bolts (D) and the seven 1/4" flat washers (E) around the outside perimeter of the pulley cover.

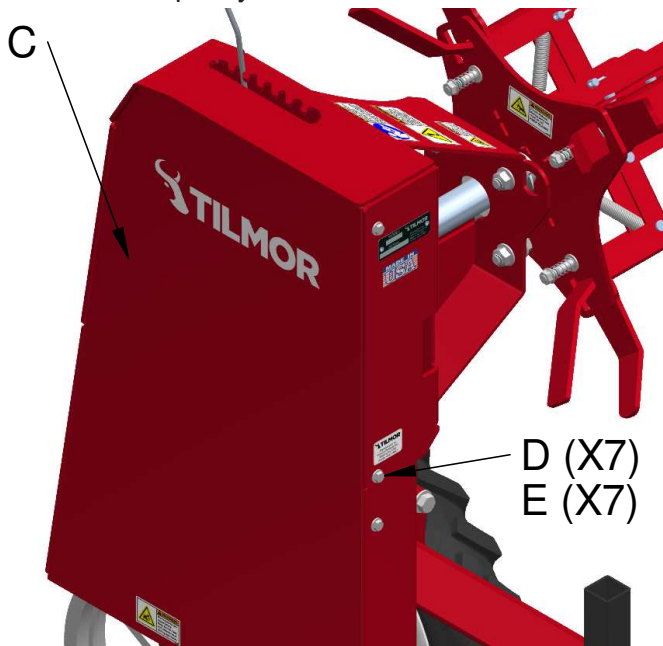

3. Remove the pulley cover (C).
4. Remove the belt from the pulleys.

5. To remove the idler pulley (E), remove the 3/8" bolt (F) secured in place by the 3/8" locking flange nut.

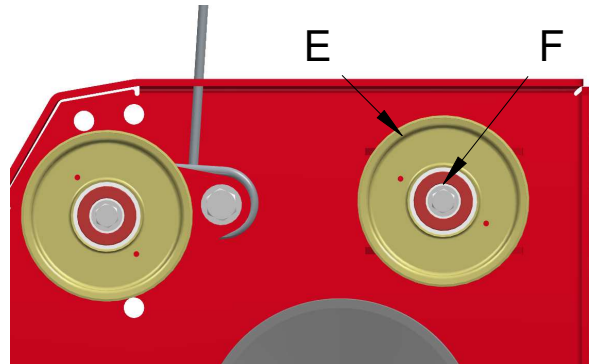

6. Remove the pulley and discard.
7. Place a 3/8" washer on the 3/8" bolt, followed by the new idler pulley and another 3/8" washer as shown below.

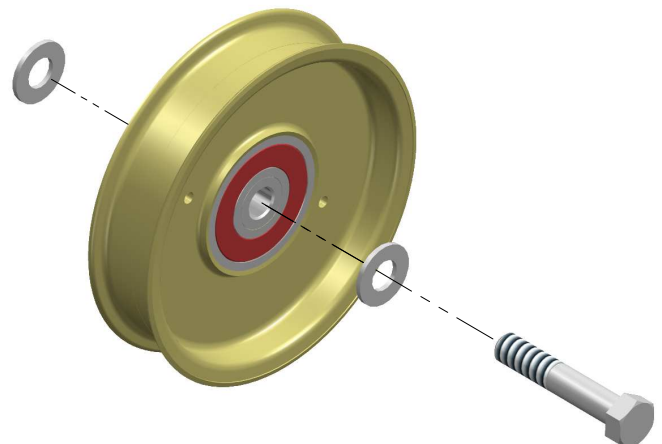

8. Install the pulley onto the pulley mount in the center mounting hole (G).

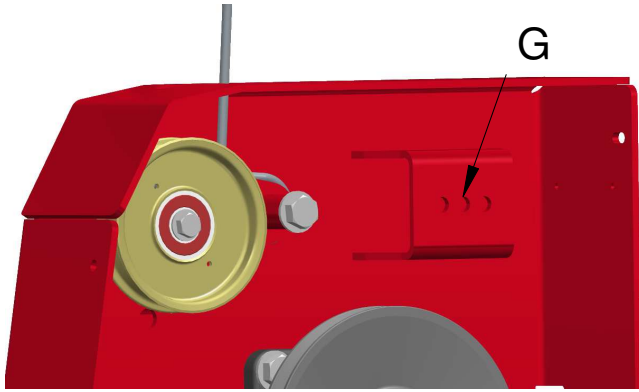

14. Reinstall the pulley cover. Torque the 1/4" bolts to 100 in-lbs (11 Nm).

9. Secure the new idler pulley in place using a 3/8" locking flange nut.
10. Torque the 3/8" bolt to 35 ft-lbs (47 Nm).
11. Ensure that the idler pulley is in line with the tensioner pulley and the reel drive pulley.
12. Install the belt, by routing the belt around the pulleys as shown below.



### Attention

NOTE: The V portion of the belt must be on the plastic winder reel drive pulley (H).

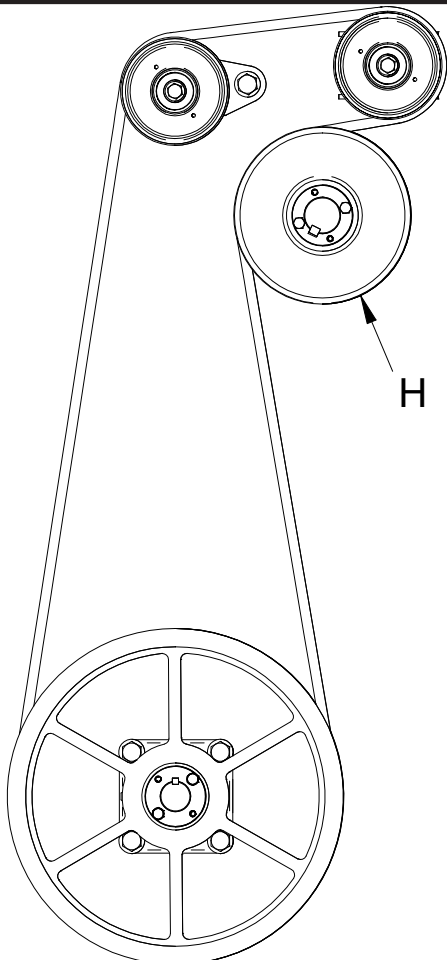

13. Set the belt tension as required by adjusting the tension adjustment lever.