

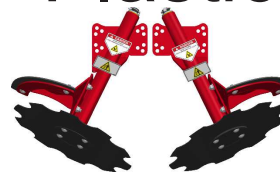

# Plastic Lifter

49.0053



Release Date: 09/25/2018  
Document Number: 12.50001  
Revision Number: 01

Go to [www.tilmor.com/resources](http://www.tilmor.com/resources) for complete parts list, additional resources and replacement part ordering.



## ATTENTION

Review safety information before operation.



## Tools

3/4" wrench  
3/4" socket  
Ratchet wrench  
Torque wrench

**Assembly Time (estimated)**

**1 hour**

## REQUIRED PARTS

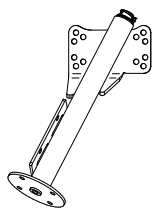
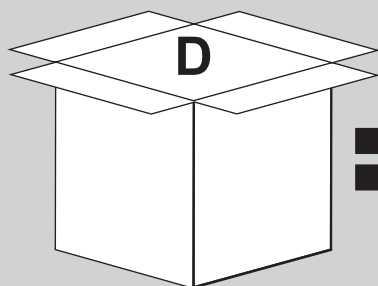

1x  
Plastic Lifter  
Assembly,  
Left

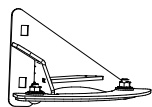

1x  
AA-6031  
Disc Guard Left

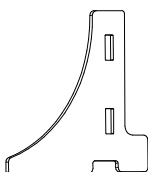

1x  
AA-1074  
Debris Removal  
Plate

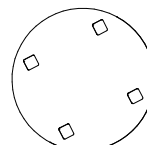

1x  
AA-1064  
End Cap

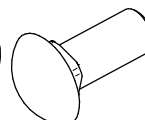

8x  
97.0810-5  
1/2" Carriage  
Bolts

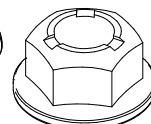

8x  
99.E0103  
1/2" Locking  
Flange Nut

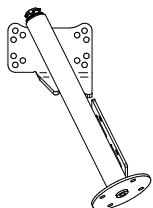
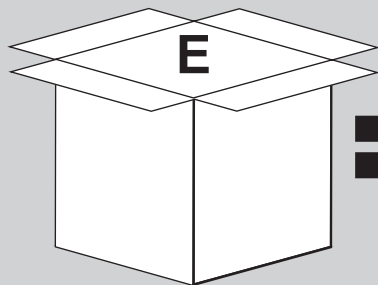

1x  
Plastic Lifter  
Assembly,  
Right

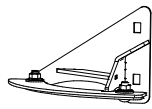

1x  
AA-6032  
Disc Guard Right

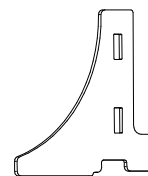

1x  
AA-1074  
Debris Removal  
Plate

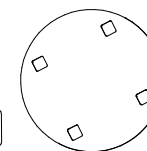

1x  
AA-1064  
End Cap

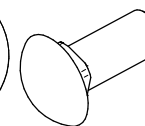

8x  
97.0810-5  
1/2" Carriage  
Bolts

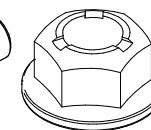

8x  
99.E0103  
1/2" Locking  
Flange Nut

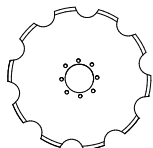
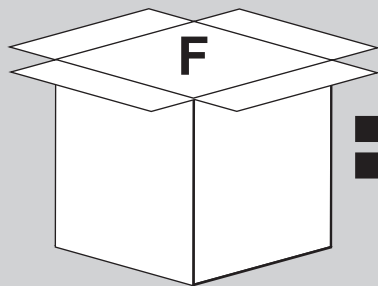

2x  
AA-3013  
Disc, Plastic  
Cutter



There is additional hardware in the box. The additional hardware is used for the installation of the plastic lifters onto a tool bar. The installation instructions are found in the Plastic Lifter Operations Manual.

# RIGHT PLASTIC LIFTER (AB-9003)(AB-9005)

 3/4" wrench, 3/4" socket, Torque Wrench

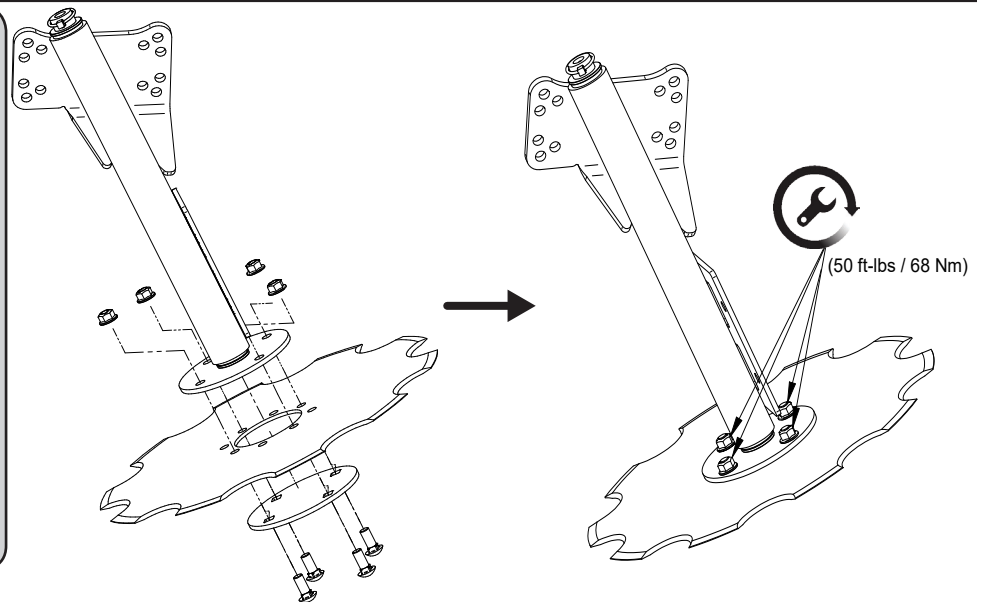
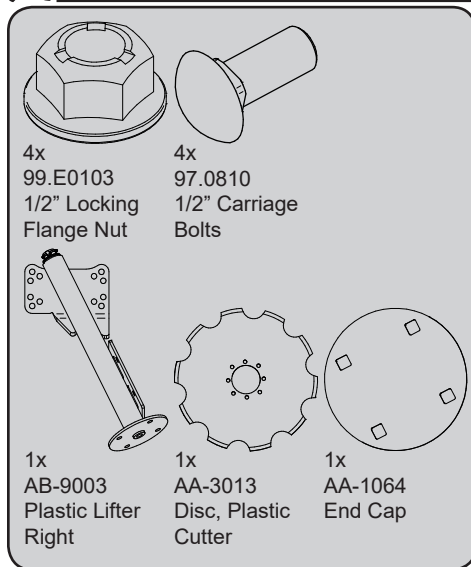

1

 3/4" wrench, 3/4" socket, Torque Wrench

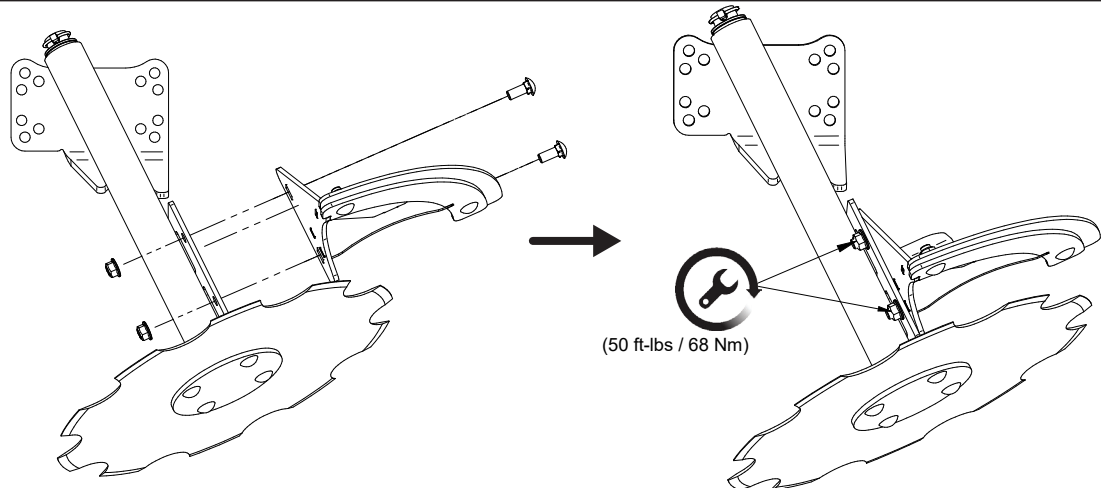
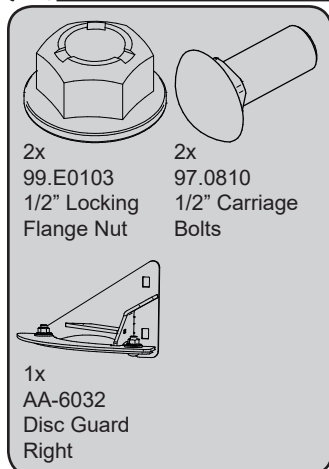

2

 3/4" wrench, 3/4" socket, Torque Wrench

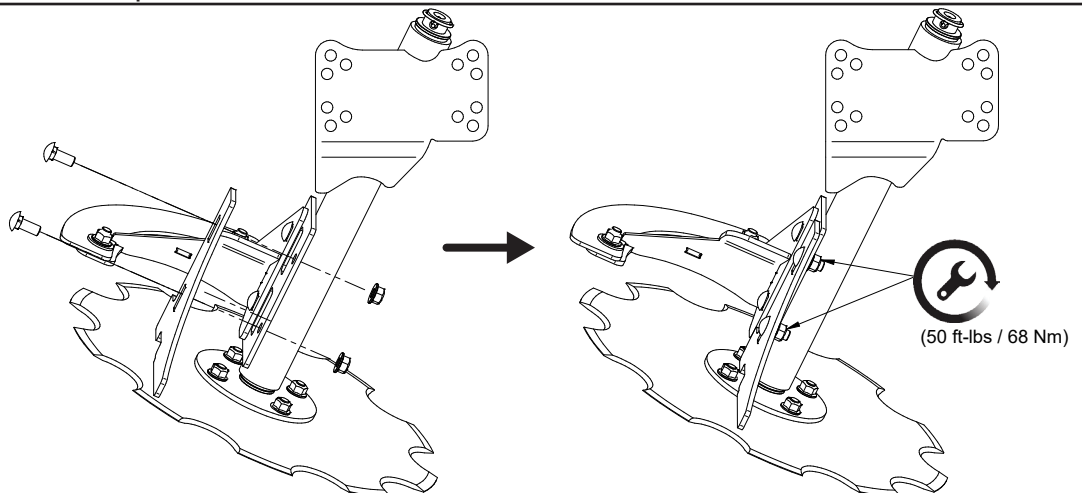
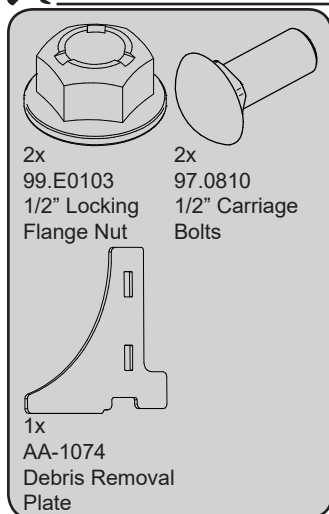

3

# LEFT PLASTIC LIFTER (AB-9004)(AB-9005)

 3/4" wrench, 3/4" socket, Torque Wrench

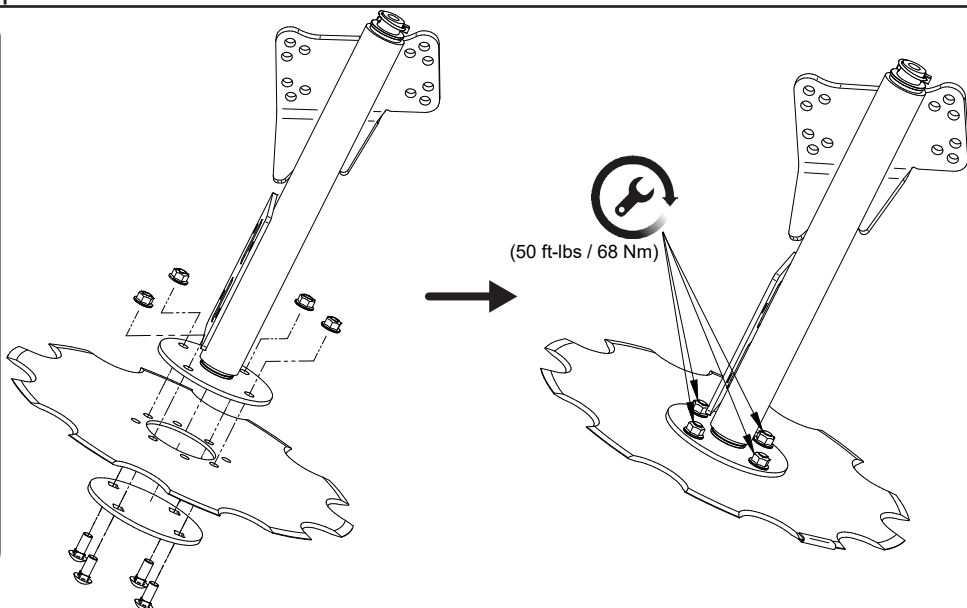
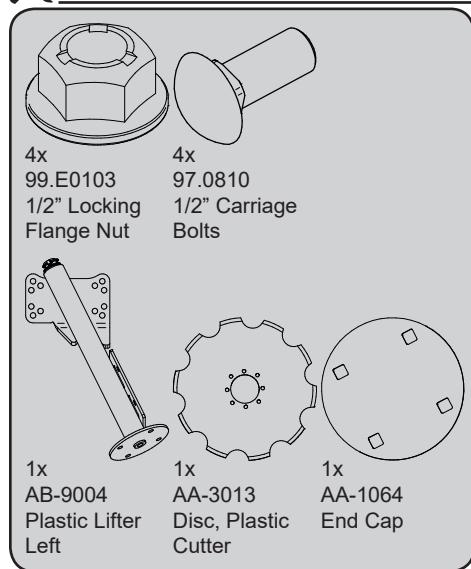

1

 3/4" wrench, 3/4" socket, Torque Wrench

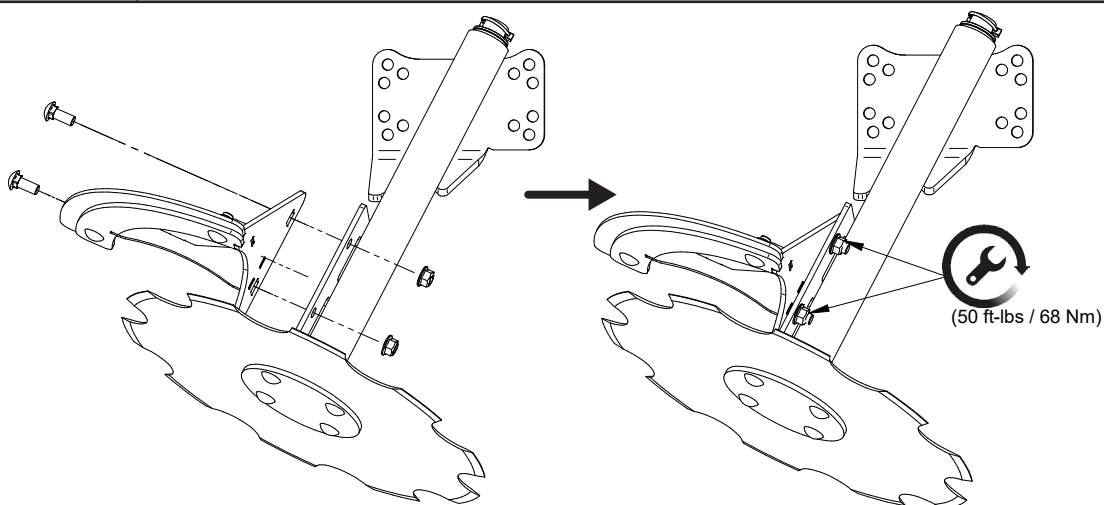
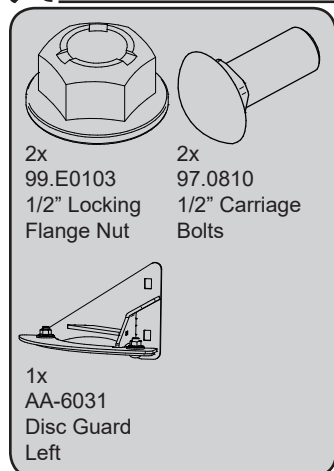

2

 3/4" wrench, 3/4" socket, Torque Wrench

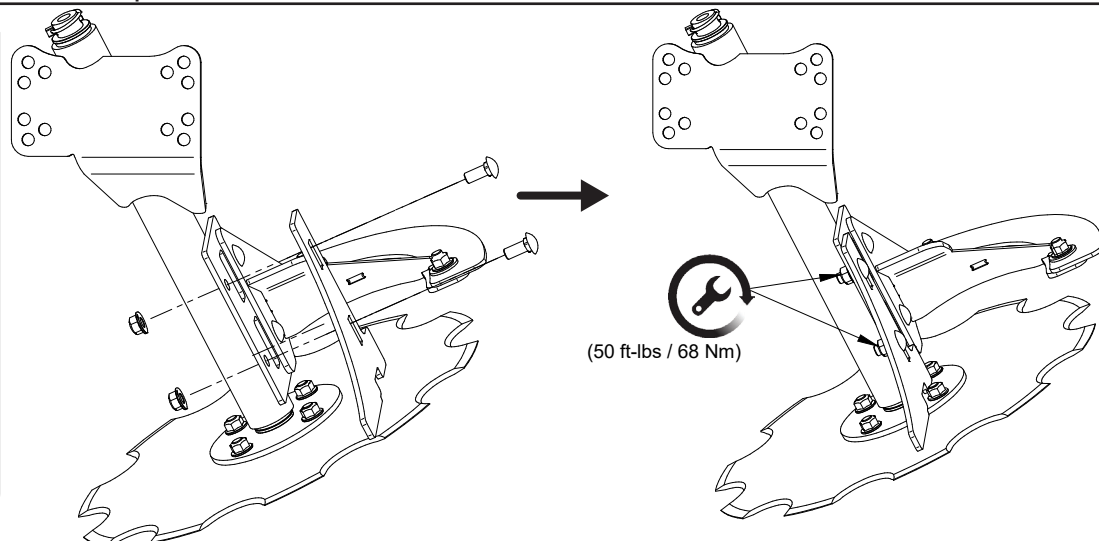
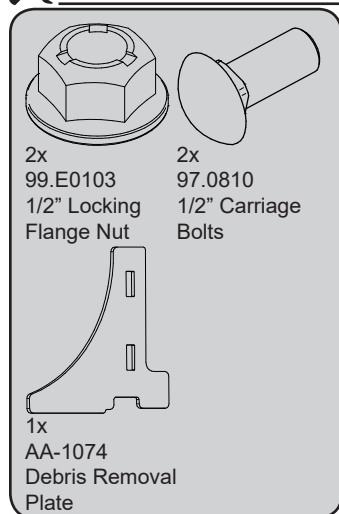

3